

# COMBINED JUDGING PROGRAM

2025118814 2025118813 2025118815 2025118817 2025118816 2025118818 2025118820 2025118819

All-Breed Dog Shows, Obedience Trials & Rally Trials  
(Unbenched)



(Member of the American Kennel Club)

**DOCK DIVING THURSDAY, FRIDAY, SATURDAY & SUNDAY PAGE 29**

**New! Bigger Cash Prizes! \$400.00 for Best in Show & Best Owner-Handled in Show!  
and \$300.00 for Reserve Best in Show & Reserve Best Owner-Handled in Show!**

**Waukesha County Exposition Center  
1000 Northview Rd., Waukesha, WI 53188**

**FRIDAY, JULY 25, 2025**

*Obedience Trial & Rally Trial & Two Fast CAT*

TRIAL HOURS: 7:00 A.M. - 7:00 P.M.

**SATURDAY, JULY 26, 2025**

*87th All-Breed Dog Show with AKC National Owner-Handled Series, Junior Showmanship, Best Bred by Exhibitor,  
Best Veteran, Obedience Trial, Rally Trial, 4-6 Beginner Puppy, Pee Wee Handling, AKC Fetch & Two Fast CAT*

SHOW & TRIAL HOURS: 7:00 A.M. - 7:00 P.M.

**SUNDAY, JULY 27, 2025**

*88th All-Breed Dog Show with AKC National Owner-Handled Series, Junior Showmanship, Top Wisconsin Junior Handler,  
Obedience & Rally Trial, 4-6 Beginner Puppy, AKC Fetch, Two Fast CAT & Best of the Best in Specialties*

SHOW & TRIAL HOURS: 7:00 A.M. - 7:00 P.M.

THE FOLLOWING TERRIERS – AMERICAN HAIRLESS, AUSTRALIAN, BEDLINGTON, CAIRN, CISKY, DANDIE DINMONT, GLEN OF IMAAL, MINIATURE SCHNAUZER, NORFOLK, NORWICH, RUSSELL, SCOTTISH, SEALYHAM, SKYE, WEST HIGHLAND WHITE, ALL TOYS, ALL NON-SPORTING\* & SHETLAND SHEEPDOGS – WILL BE JUDGED INDOORS. ALL OTHER BREED JUDGING WILL BE OUTDOORS. OBEDIENCE TRIALS & RALLY TRIALS WILL BE INDOORS. NO CONFORMATION DOGS WILL BE SHOWN IN THE PERFORMANCE BUILDING. \*DALMATIANS & XOLOITZCUINTLI WILL BE JUDGED OUTDOORS, DANISH-SWEDISH FARM DOGS MAY BE JUDGED INDOORS OR OUTDOORS.

For more information: [www.waukeshakennelclub.org/summersplashdogshow](http://www.waukeshakennelclub.org/summersplashdogshow)



**IS THE OFFICIAL SPONSOR  
OF OUR EVENTS**

1851 Waukesha Kennel Club, Inc. OBED, Friday - July 25, 2025  
1512 Waukesha Kennel Club, Inc., Saturday - July 26, 2025  
1652 Waukesha Kennel Club, Inc., Sunday - July 27, 2025

This index has been prepared to enable exhibitors to (1) identify the Ring(s) in which their Breed(s) is (are) to be judged and (2) have an approximation of the number of dogs entered. The entry figures are not to be taken as a representation on the part of the Superintendent/Show Secretary that all dogs entered will be present on the Show day.

	Friday		Saturday		Sunday	
	RING	TIME	RING	TIME	RING	TIME
Affenpinschers			2	9:00 AM	2	12:45 PM
Afghan Hounds			13	10:30 AM	12	9:30 AM
Airedale Terriers			6	9:30 AM	6	10:00 AM
Airedale Terriers SWP			6	8:45 AM	6	9:30 AM
Airedale Terriers VSW			6	8:45 AM	6	9:30 AM
Akitas			12	1:15 PM	9	10:30 AM
Alaskan Malamutes			10	9:00 AM	10	8:00 AM
American English Coonhounds			13	10:30 AM		
American Eskimo Dogs			1	12:45 PM	1	9:00 AM
American Hairless Terriers			3	8:00 AM	3	8:00 AM
American Staffordshire Terriers			14	1:00 PM	5	9:15 AM
Australian Cattle Dogs			9	1:00 PM	14	10:30 AM
Australian Shepherds			9	10:45 AM	11	9:30 AM
Australian Terriers			3	8:00 AM	3	8:00 AM
Basenjis			12	10:00 AM	8	12:45 PM
Basset Hounds			13	9:00 AM	12	8:00 AM
Beagles, 13 Inch			12	9:00 AM	12	1:00 PM
Beagles, 15 Inch			12	8:00 AM	12	1:00 PM
Bearded Collies			11	10:00 AM	9	12:30 PM
Beaucerons			9	1:00 PM	9	12:30 PM
Bedlington Terriers			3	8:00 AM	3	8:00 AM
Belgian Laekenois			11	10:00 AM	9	12:30 PM
Belgian Malinois			11	9:00 AM	9	10:30 AM
Belgian Sheepdogs			11	10:00 AM	9	12:30 PM
Belgian Tervuren			10	10:00 AM	9	12:30 PM
Berger Picards			5	12:30 PM	14	8:00 AM
Bernese Mountain Dogs			15	8:30 AM	15	8:00 AM
Bernese Mountain Dogs SWP			15	8:00 AM		
Bernese Mountain Dogs VSW			15	8:00 AM		
Bichons Frises			1	12:45 PM	1	12:15 PM
Biewer Terriers			2	10:00 AM	2	8:00 AM
Boerboels			9	1:00 PM	11	8:00 AM
Border Collies			6	8:00 AM	9	12:30 PM
Border Terriers			14	1:00 PM	5	10:45 AM
Borzoi			12	9:00 AM	12	9:30 AM
Boston Terriers			1	9:15 AM	1	10:00 AM
Boxers			10	8:00 AM	13	8:00 AM
Bracchi Italiani			11	10:00 AM	5	9:15 AM
Briards			9	1:00 PM	9	12:30 PM
Brittanys			11	10:00 AM	7	1:45 PM
Brussels Griffons			1	9:15 AM	1	12:15 PM
Bull Terriers (Colored)			14	1:00 PM	5	10:45 AM
Bull Terriers (White)			14	1:00 PM	5	10:45 AM
Bulldogs			1	8:00 AM	1	12:15 PM
Bullmastiffs			15	10:00 AM	11	8:00 AM
Cairn Terriers			3	8:00 AM	3	8:00 AM
Canaan Dogs			11	10:00 AM	9	12:30 PM
Cane Corsos			9	1:00 PM	11	8:00 AM

	Friday	Saturday	Sunday
	RING TIME	RING TIME	RING TIME
Cardigan Welsh Corgis	8	12:00 NOON	14 9:00 AM
Cardigan Welsh Corgis SWP	8	11:00 AM	
Cardigan Welsh Corgis VSW	8	11:00 AM	
Cavalier King Charles Spaniels	2	12:15 PM	2 10:45 AM
Chihuahuas (Long Coat)	3	9:15 AM	2 9:00 AM
Chihuahuas (Smooth Coat)	3	9:15 AM	2 8:00 AM
Chinese Cresteds	2	8:00 AM	1 8:00 AM
Chinese Shar-Pei	1	11:30 AM	1 11:00 AM
Chow Chows	1	8:00 AM	1 12:15 PM
Collies (Rough)	6	8:00 AM	6 12:00 NOON
Collies (Smooth)	6	8:00 AM	6 12:00 NOON
Cotons de Tulear	1	8:00 AM	1 12:00 NOON
Dachshunds (Longhaired)	13	9:00 AM	12 8:00 AM
Dachshunds (Smooth)	13	9:00 AM	12 8:00 AM
Dachshunds (Wirehaired)	13	9:00 AM	12 8:00 AM
Dalmatians	7	9:30 AM	9 10:30 AM
Danish-Swedish Farmdogs	1	12:45 PM	11 1:15 PM
Doberman Pinschers	9	8:00 AM	9 8:00 AM
English Toy Spaniels (KC & R)	2	9:00 AM	2 9:00 AM
Finnish Lapphunds	9	8:00 AM	11 11:00 AM
Fox Terriers (Smooth)	14	1:00 PM	8 12:45 PM
French Bulldogs	1	8:00 AM	1 8:00 AM
German Shepherd Dogs	10	10:00 AM	10 12:30 PM
German Spitz	12	8:00 AM	9 12:30 PM
Glen of Imaal Terriers	3	8:00 AM	3 9:00 AM
Great Danes	8	8:00 AM	8 8:00 AM
Great Pyrenees	15	12:00 NOON	11 8:00 AM
Greater Swiss Mountain Dogs	9	8:00 AM	9 8:00 AM
Greyhounds	12	8:00 AM	12 1:00 PM
Harriers	12	8:00 AM	12 1:00 PM
Havanese	1	9:15 AM	1 12:15 PM
Icelandic Sheepdogs	9	1:00 PM	11 1:15 PM
Irish Terriers	6	10:30 AM	5 9:15 AM
Irish Wolfhounds	12	8:00 AM	12 1:00 PM
Junior Showmanship Novice Jr	14	8:00 AM	7 8:00 AM
Junior Showmanship Novice Int	14	8:00 AM	7 8:00 AM
Junior Showmanship Novice Sr	14	8:00 AM	7 8:00 AM
Junior Showmanship Open Jr	14	8:00 AM	7 8:00 AM
Junior Showmanship Open Int	14	8:00 AM	7 8:00 AM
Junior Showmanship Open Sr	14	8:00 AM	7 8:00 AM
Junior Showmanship JMaster	14	8:00 AM	7 8:00 AM
Junior Showmanship BJ	14	8:00 AM	7 8:00 AM
Junior Showmanship Top JH			14 12:00 NOON
Keeshonden	1	11:30 AM	1 11:00 AM
Keeshonden SWP	1	11:00 AM	
Keeshonden VSW	1	11:00 AM	
Kerry Blue Terriers	6	10:30 AM	6 10:00 AM
Kuvaszok	12	1:15 PM	11 8:00 AM
Lagotti Romagnoli	11	10:00 AM	5 9:15 AM
Lakeland Terriers	6	10:30 AM	8 12:45 PM
Leonbergers	15	10:00 AM	11 8:00 AM
Lhasa Apsos	1	12:45 PM	1 12:00 NOON
Lowchen	1	8:00 AM	1 12:00 NOON
Maltese	2	10:00 AM	2 12:45 PM

	Friday		Saturday		Sunday	
	RING	TIME	RING	TIME	RING	TIME
Manchester Terriers (Toy)					2	12:45 PM
Miniature American Shepherds					11	1:15 PM
Miniature Bull Terriers			6	8:00 AM	5	9:15 AM
Miniature Pinschers			14	1:00 PM	2	12:45 PM
Miniature Schnauzers			2	8:00 AM	3	9:00 AM
Mudik			3	12:15 PM	11	11:00 AM
Nederlandse Kooikerhondjes			5	11:45 AM	5	8:00 AM
Newfoundlands			11	10:00 AM	11	8:00 AM
Norfolk Terriers			15	10:00 AM	3	8:00 AM
Norwegian Elkhounds			3	8:00 AM	6	12:00 NOON
Norwegian Lundehunds			13	10:30 AM	1	9:00 AM
Norwich Terriers			1	8:00 AM	3	8:00 AM
Obedience Novice A	16	11:05 AM	3	8:00 AM		
Obedience Novice B	16	11:05 AM	16	10:40 AM		
Obedience Open A	16	10:35 AM	16	10:40 AM	16	10:45 AM
Obedience Opn B & Pre Opn	16	11:05 AM	16	10:25 AM	16	10:05 AM
Obedience Utility A	16	9:55 AM	16	10:40 AM	16	10:45 AM
Obedience Util B & Pre Util	16	8:00 AM	16	9:55 AM	16	9:45 AM
Obedience Pref Nov	16	11:05 AM	16	8:00 AM	16	8:00 AM
Obedience Begin Novice A	16	11:05 AM	16	10:40 AM	16	10:45 AM
Obedience Begin Novice B	16	11:05 AM	16	10:40 AM	16	10:45 AM
Obedience Graduate Novice	16	11:05 AM	16	10:40 AM	16	10:45 AM
Obedience Graduate Open	16	10:15 AM	16	10:15 AM	16	9:55 AM
Obedience Veterans Class			16	10:40 AM		
Old English Sheepdogs			9	10:45 AM	14	8:00 AM
Otterhounds			13	10:30 AM	6	12:00 NOON
Papillons			2	10:00 AM	2	10:45 AM
Pekingese			2	9:00 AM	2	9:00 AM
Pembroke Welsh Corgis			6	11:00 AM	10	8:00 AM
Petits Bassets Griffons Vendeens			13	10:30 AM	6	12:00 NOON
Pointers			11	10:00 AM	5	10:45 AM
Pointers (German Shorthaired)			4	9:30 AM	6	12:00 NOON
Pointers (German Wirehaired)			5	9:00 AM	4	9:15 AM
Polish Lowland Sheepdogs			5	11:45 AM	9	12:30 PM
Pomeranians			2	9:00 AM	2	10:45 AM
Poodles (Miniature)			3	12:20 PM	3	11:30 AM
Poodles (Standard)			3	12:20 PM	3	11:30 AM
Poodles (Toy)			3	12:20 PM	3	11:30 AM
Portuguese Podengo Pequenos			12	8:00 AM	7	11:45 AM
Portuguese Water Dogs			15	11:00 AM	11	11:00 AM
Pugs			2	8:00 AM	1	12:15 PM
Pyrenean Shepherds			9	1:00 PM	9	12:30 PM
Redbone Coonhounds			12	8:00 AM	12	1:00 PM
Ret (Nova Scotia Duck Tolling)			11	9:00 AM	5	1:15 PM
Retrievers (Chesapeake Bay)			11	8:00 AM	4	9:15 AM
Retrievers (Curly-Coated)			11	8:00 AM	5	8:00 AM
Retrievers (Flat-Coated)			4	8:00 AM	5	8:00 AM
Retrievers (Golden)			7	12:30 PM	4	12:00 NOON
Retrievers (Labrador)			7	8:00 AM	4	12:00 NOON
Rhodesian Ridgebacks			11	12:30 PM	10	12:30 PM
Rhodesian Ridgebacks SWP			11	12:15 PM		
Rhodesian Ridgebacks VSW			11	12:15 PM		
Rottweilers			10	8:00 AM	9	10:30 AM
Russell Terriers			3	8:00 AM	3	8:00 AM

	Friday RING TIME	Saturday RING TIME	Sunday RING TIME
Russian Toys		2 12:15 PM	2 12:45 PM
Saint Bernards		15 12:00 NOON	11 8:00 AM
Salukis		13 10:30 AM	6 12:00 NOON
Samoyeds		12 1:15 PM	11 1:15 PM
Schipperkes		1 12:45 PM	1 10:00 AM
Scottish Deerhounds		12 8:00 AM	12 1:00 PM
Scottish Terriers		2 11:00 AM	3 9:00 AM
Setters (English)		4 1:00 PM	15 10:20 AM
Setters (English) SWP		4 12:15 PM	
Setters (Gordon)		7 8:00 AM	15 9:20 AM
Setters (Irish Red and White)		7 9:30 AM	7 1:45 PM
Setters (Irish)		7 10:30 AM	7 11:45 AM
Setters (Irish) SWP		7 10:00 AM	
Setters (Irish) VSW		7 10:00 AM	
Shetland Sheepdogs		3 11:00 AM	3 9:45 AM
Shiba Inu		1 12:45 PM	1 9:00 AM
Shih Tzu		2 11:00 AM	2 10:00 AM
Siberian Huskies		12 1:15 PM	13 8:00 AM
Silky Terriers		2 10:00 AM	2 12:45 PM
Soft Coated Wheaten Terriers		14 10:45 AM	14 11:30 AM
Spaniels (American Water)		7 9:30 AM	4 9:15 AM
Spaniels (Boykin)		11 10:00 AM	5 9:15 AM
Spaniels (Clumber)		7 8:00 AM	15 9:20 AM
Spaniels (Cocker) A.S.C.O.B.		4 8:45 AM	5 10:45 AM
Spaniels (Cocker) Black		4 8:45 AM	5 10:45 AM
Spaniels (English Cocker)		4 8:45 AM	5 12:30 PM
Spaniels (English Springer)		5 11:00 AM	5 9:15 AM
Spaniels (Field)		5 9:00 AM	4 9:15 AM
Spaniels (Irish Water)		11 10:00 AM	5 12:30 PM
Spaniels (Welsh Springer)		4 8:45 AM	5 9:15 AM
Spanish Water Dogs		8 9:45 AM	7 10:45 AM
Spinoni Italiani		11 10:00 AM	5 10:45 AM
Staffordshire Bull Terriers		14 1:00 PM	5 9:15 AM
Standard Schnauzers		15 12:00 NOON	11 1:15 PM
Swedish Vallhunds		9 1:00 PM	9 12:30 PM
Teddy Roosevelt Terriers		12 8:00 AM	9 12:30 PM
Tibetan Spaniels		1 12:45 PM	1 9:00 AM
Tibetan Terriers		1 12:45 PM	1 9:00 AM
Toy Fox Terriers		2 8:00 AM	2 12:45 PM
Treeing Walker Coonhounds		13 9:00 AM	12 1:00 PM
Vizslas		15 1:00 PM	5 1:15 PM
Weimaraners		11 8:00 AM	5 10:45 AM
West Highland White Terriers		3 8:00 AM	3 9:00 AM
Whippets		13 11:45 AM	12 10:30 AM
Whippets SWP		13 11:00 AM	
Wirehaired Pointing Griffons		5 8:00 AM	4 8:00 AM
Xoloitzcuintli		7 8:00 AM	9 12:30 PM
Yakutian Laikas		12 8:00 AM	9 12:30 PM
Yorkshire Terriers		2 12:15 PM	2 12:45 PM

---

Emergency Contact: Jennifer Staggs (262) 993-5119

---

**NOTE:**

AKC Weekend Club Hotline: (919) 816-3955 or visit the AKC Event Cancellations page at:  
<https://www.akc.org/sports/event-cancellations/> for event cancellation information.

1916 Waukesha Kennel Club, Inc. RALLY, Friday - July 25, 2025  
6122 Waukesha Kennel Club, Inc. RALLY, Saturday - July 26, 2025  
6124 Waukesha Kennel Club, Inc. RALLY, Sunday - July 27, 2025

	Friday		Saturday		Sunday	
	RING	TIME	RING	TIME	RING	TIME
Rally Nov A	17	10:30 AM	17	11:35 AM	17	11:20 AM
Rally Nov B	17	10:30 AM	17	11:35 AM	17	11:20 AM
Rally Intermed	17	10:30 AM	17	11:35 AM	17	11:20 AM
Rally Adv A	17	10:30 AM	17	11:15 AM	17	11:00 AM
Rally Adv B	17	10:30 AM	17	11:35 AM	17	11:20 AM
Rally Ex A	17	10:15 AM	17	9:35 AM	17	9:30 AM
Rally Ex B	17	10:30 AM	17	9:50 AM	17	9:50 AM
Rally Master	17	8:35 AM	17	8:20 AM	17	8:25 AM
Rally Choice	17	8:00 AM	17	8:00 AM	17	8:00 AM

6123 Waukesha Kennel Club, Inc. 4-6 Months Puppy, Saturday - July 26, 2025  
6125 Waukesha Kennel Club, Inc. 4-6 Months Puppy, Sunday - July 27, 2025

	Saturday		Sunday	
	RING	TIME	RING	TIME
Airedale Terriers	6	12:30 PM	13	9:30 AM
American Hairless Terriers	6	12:30 PM	13	9:30 AM
Bernese Mountain Dogs	6	12:30 PM	13	9:30 AM
Border Terriers	6	12:30 PM		
Chihuahuas (Long Coat)	6	1:30 PM	13	9:30 AM
Dachshunds (Smooth)	6	1:30 PM	13	10:30 AM
Dalmatians	6	1:30 PM	13	10:30 AM
Danish-Swedish Farmdogs	6	12:30 PM	13	9:30 AM
Doberman Pinschers	6	12:30 PM	13	9:30 AM
English Toy Spaniels (B & PC)	6	1:30 PM	13	9:30 AM
French Bulldogs	6	1:30 PM		
German Shepherd Dogs	6	1:30 PM	13	10:30 AM
Great Danes	6	12:30 PM	13	9:30 AM
Lakeland Terriers	6	12:30 PM	13	9:30 AM
Leonbergers	6	12:30 PM	13	9:30 AM
Miniature Bull Terriers	6	12:30 PM	13	9:30 AM
Mudik	6	1:30 PM		
Norfolk Terriers	6	12:30 PM	13	9:30 AM
Pembroke Welsh Corgis	6	1:30 PM		
Pointers (German Shorthaired)	6	1:30 PM		
Pomeranians	6	1:30 PM	13	9:30 AM
Retrievers (Flat-Coated)			13	10:30 AM
Retrievers (Golden)	6	1:30 PM	13	10:30 AM
Retrievers (Labrador)	6	1:30 PM	13	10:30 AM
Samoyeds	6	12:30 PM	13	9:30 AM
Setters (English)	6	1:30 PM	13	10:30 AM
Setters (Gordon)	6	1:30 PM	13	10:30 AM
Shetland Sheepdogs	6	1:30 PM	13	10:30 AM
Soft Coated Wheaten Terriers	6	12:30 PM	13	9:30 AM
Spaniels (Field)	6	1:30 PM	13	10:30 AM
Whippets	6	1:30 PM	13	10:30 AM

**Site available Thursday, July 24 after 12:00 Noon.**  
**The Show Chair will not exhibit in Conformation at these shows.**

## DESIGNATED SPECIALTY SHOWS

### SATURDAY ONLY

German Shorthaired Pointer Club of Wisconsin  
Irish Setter Club of Milwaukee, Inc.  
(Sweepstakes & Veteran Sweepstakes)  
Wirehaired Pointing Griffon Club of the Midwest  
Basenji Club of Southeastern Wisconsin  
Bernese Mountain Dog Club of Southeastern Wisconsin  
(Sweepstakes & Veteran Sweepstakes)

Wisconsin Airedale Terrier Club  
(Sweepstakes & Veteran Sweepstakes)  
Keeshond Fanciers of the Central States  
(Sweepstakes & Veteran Sweepstakes)  
Berger Picard Club of America

### SATURDAY & SUNDAY

German Wirehaired Pointer Club of Wisconsin  
Kettle Moraine English Setter Club  
(Sweepstakes - Saturday Only)  
Doberman Pinscher Club of Greater Milwaukee  
Great Dane Club of Milwaukee, Inc.  
Milshore Miniature Schnauzer Club  
Soft Coated Wheaten Terrier Club of Greater Milwaukee

Chihuahua Club of Greater Milwaukee, Inc.  
Shih Tzu Club of Southeastern Wisconsin  
Boston Terrier Club of Milwaukee  
German Shepherd Dog Club of Wisconsin  
Lakeshore Pembroke Welsh Corgi Club  
Chicagoland Shetland Sheepdog Club, Inc.  
Spanish Water Dog Club of America

### SUNDAY ONLY

Fox River Field Spaniel Club  
Airedale Terrier Club of Illinois (Sweepstakes & Veteran Sweepstakes)

### SUPPORTED ENTRIES

#### SATURDAY ONLY

Fox River Field Spaniel Club  
American Whippet Club, Inc.  
(Sweepstakes & Veteran Sweepstakes)

Cardigan Welsh Corgi Club of America, Inc.  
(Sweepstakes & Veteran Sweepstakes)

#### SATURDAY & SUNDAY

Wisconsin English Springer Spaniel Association, Inc.  
Midwest Borzoi Club  
Rhodesian Ridgeback Club of the United States, Inc.  
(Sweepstakes & Veteran Sweepstakes - Saturday)

Alaskan Malamute Club of Wisconsin  
Medallion Rottweiler Club  
Greater Milwaukee Poodle Club  
Great Lakes French Bulldog Club

### SUNDAY ONLY

German Shorthaired Pointer Club of Wisconsin  
Irish Setter Club of Milwaukee, Inc.  
Wirehaired Pointing Griffon Club of the Midwest  
Bernese Mountain Dog Club of Southeastern Wisconsin  
Berger Picard Club of America

---

***The Waukesha Kennel Club would like to thank the Specialties, Supported Entries and Breed Fanciers for their trophy donations and their support of our shows!***

---

For more information:

[www.waukeshakennelclub.org/summersplashdogshow](http://www.waukeshakennelclub.org/summersplashdogshow)

**NEW TITLE ROSETTES** will be Awarded to dogs receiving new titles at these shows. Waukesha Kennel Club, Inc. will offer a Rosette to any dog which completes its Obedience, Rally or Conformation title at these shows. Rosettes will be available for Friday, Saturday & Sunday shows at the WKC information table.

**EQUIPMENT & SERVICE FURNISHED BY:**  **MB-F<sup>®</sup> Inc.**

*"Please feel free to come by and take a tour of our Headquarters Office in NC any business day Mon. thru Fri., 9:00 A.M. to 4:00 P.M."*

620 Industrial Ave. • P.O. Box 22107 • Greensboro, NC 27420 • 336-379-9352  
32351 Edward Ave. • P.O. Box 9999 • Madison Hts., MI 48071 • 248-588-5000  
FAX - 336-272-0864 • Internet Address <http://www.infodog.com>  
E-Mail Address [mbf@infodog.com](mailto:mbf@infodog.com)

AMERICAN KENNEL CLUB ANNUALLY LICENSED SUPERINTENDENT  
*Member of the Dog Show Superintendents Association • [dogshowsupers.org](http://dogshowsupers.org)*

## PROGRAM OF JUDGING - FRIDAY - JULY 25, 2025

There are 52 dogs in these trials with a total entry of 63, including 63 obedience entries and 79 dogs and 130 rally entries. For your convenience, the following class divisions have been carefully tabulated; however, neither the Club nor the Superintendent or Show Secretary assumes responsibility for absolute accuracy.

**Obedience/Rally Contact:**  
**Donna Schmidt (920) 285-4842**

**RING SIXTEEN**  
**JUDGE: Mr. James Comunale**

**(Judge will take a 45 minute luncheon break at his discretion)**

**8:00 AM**

- 13 Utility Class B & Preferred Utility Obedience Entries  
Nos P55 P58 31 34 36 40 41 35 44 45 46 47 48

**9:55 AM**

- 2 Utility Class A Obedience Entries  
Nos 49 50

**10:15 AM**

- 2 Graduate Open Class Obedience Entries  
Nos 76 77

**10:35 AM**

- 4 Open Class A Obedience Entries  
Nos 25 26 28 30

**11:05 AM**

- 15 Open Class B & Preferred Open Obedience Entries  
Nos P55 P56 P57 31 33 36 40 41 35 43 44 45 46 47 48

**After Noon**

- 1 Graduate Novice Class Obedience Entries  
Nos 74

**After Noon**

- 11 Novice Class B Obedience Entries  
Nos 8 9 11 12 16 17 18 19 22 23 24

**After Noon**

**A combined 5 minute walk-thru prior to the start of Novice Class A & the Preferred Novice Class will be allowed for handlers without their dogs**

Class to follow

- 2 Novice Class A Obedience Entries  
Nos 5 7  
3 Preferred Novice Class Obedience Entries  
Nos P52 P53 P54

**After Noon**

**A combined 10 minute walk-thru prior to the start of the Beginner Novice Classes will be allowed for handlers without their dogs**

Class to follow

- 4 Beginner Novice Class A Obedience Entries  
Nos 59 60 62 63  
6 Beginner Novice Class B Obedience Entries  
Nos 64 65 66 67 70 71

**RING SEVENTEEN**  
**JUDGE: Mrs. Anna Lorenz**

**(Judge will take a 45 minute luncheon break at her discretion)**

**8:00 AM**

- Rally Choice Class Walk Thru  
Class to Follow  
7 Rally Choice Class  
Nos 62 87 116 125 127 128 129

**8:35 AM**

- Rally Master Class Walk Thru  
Class to Follow  
30 Rally Master Class  
Nos 62 63 65 116 117 118 119 67 68 70 120 77 78 83 84 87 88 89 90 92 93 95 99 101 104 105 106 121 123 125

**10:15 AM**

- Rally Excellent Class A Walk Thru  
Class to Follow  
1 Rally Excellent Class A  
Nos 108

**10:30 AM**

- Rally Excellent Class B Walk Thru  
Class to Follow  
32 Rally Excellent Class B  
Nos 62 63 65 109 67 68 70 110 111 112 75 77 78 83 84 87 88 89 90 92 93 95 96 98 99 101 104 105 106 113 114 115

**After Noon**

- Rally Advanced Class A Walk Thru  
Class to Follow  
1 Rally Advanced Class A  
Nos 56

**After Noon**

- Rally Advanced Class B Walk Thru  
Class to Follow  
29 Rally Advanced Class B  
Nos 62 63 65 67 68 69 70 74 75 77 78 83 84 87 88 89 90 92 93 94 95 96 98 99 101 102 104 105 106

**After Noon**

- Rally Intermediate Class Walk Thru  
Class to Follow  
5 Rally Intermediate Class  
Nos 47 48 52 53 54

**After Noon**

- Rally Novice Class A Walk Thru  
Class to Follow  
9 Rally Novice Class A  
Nos 8 10 11 14 16 18 19 20 21

**After Noon**

- Rally Novice Class B Walk Thru  
Class to Follow  
16 Rally Novice Class B  
Nos 22 23 24 26 27 28 29 33 34 35 38 40 41 42 43 44

---

**THE AMERICAN KENNEL CLUB IS COMMITTED** to creating a safe and respectful sport environment for all. If you need to talk to someone, or need help, please call (800) 656-HOPE (National Sexual Assault Hotline) or text HOME to 741-741 for free, 24/7, confidential services from trained crisis counselors.

## PROGRAM OF JUDGING - SATURDAY - JULY 26, 2025

There are 1709 dogs in this show & trials with a total entry of 1845 in 170 different Breeds or Varieties, including 66 obedience entries and 81 dogs and 119 rally entries. Additionally there are 186 dogs and 218 entries in Concurrent events and 1 4-6 Puppy entries. For your convenience, the following division of sexes has been carefully tabulated; however, neither the Club nor the Superintendent or Show Secretary assumes responsibility for absolute accuracy.

In accordance with Chapter 7, Section 13 of "Rules Applying to Dog Shows" due to the large entry and with American Kennel Club Approval the following changes apply:

Breed	Original Judge	New Judge
Nederlandse Kooikerhondjes	Mr. David L. Kittredge	* Mrs. Linda Clark
Spaniels (Boykin)	Mr. David L. Kittredge	* Mrs. Linda Clark

In accordance with Chapter 7, Section 8, of "Rules Applying to Dog Shows" and with American Kennel Club Approval the following changes apply:

Breed	Original Judge	New Judge
Bracchi Italiani	Mr. Benjamin Sanchez Garcia	* Mrs. Linda Clark
Lagotti Romagnoli	Mr. Benjamin Sanchez Garcia	* Mrs. Linda Clark
Pointers	Mr. Benjamin Sanchez Garcia	Mrs. Linda Clark
Spaniels (Irish Water)	Mr. Benjamin Sanchez Garcia	* Mrs. Linda Clark
Spinoni Italiani	Mr. Benjamin Sanchez Garcia	* Mrs. Linda Clark
Alaskan Malamutes	Ms. Rita J. Biddle, Esq.	Ms. Joyce Siddall
Boerboels	Ms. Rita J. Biddle, Esq.	Mrs. Jo Ann Pavey
Boxers	Ms. Rita J. Biddle, Esq.	Ms. Joyce Siddall
Cane Corsos	Mr. Benjamin Sanchez Garcia	Mrs. Jo Ann Pavey
Newfoundlands	Ms. Rita J. Biddle, Esq.	Mrs. Abigail S. Patrizio
Rottweilers	Ms. Rita J. Biddle, Esq.	Ms. Joyce Siddall
Saint Bernards	Mr. Benjamin Sanchez Garcia	Mrs. Abigail S. Patrizio
Best Owner-Handled in Show	Mr. Benjamin Sanchez Garcia	Mrs. Kalen M. Dumke Voogt

The number before each Breed (Variety) indicates the number of dogs entered in that Breed (Variety). The numbers following each Breed (Variety) indicate the number of Regular Class Dogs, Regular Class Bitches, Best of Breed (Variety) (Dogs-Bitches), and Non-Regular Class Dogs or Bitches.

### RING ONE

**JUDGE: Mr. Raymond V. Filburn, Jr.**

#### 8:00 AM

- 1 Bulldogs 0-0-(1-0)
- 2 Chow Chows 0-0-(2-0)
- 1 Cotons de Tulear 0-0-(0-1)
- 1 Lowchen 0-0-(1-0)
- 6 Norwegian Lundehunds 1-3-(1-1)
- 20 French Bulldogs 6-7-(4-3)

#### 9:15 AM

- 7 Brussels Griffons 1-3-(3-0)
- 6 Havanese 3-1-(2-0)

#### Specialty

- 28 Boston Terriers 7-11-(5-3)-2

See Ring 3 at 12:20 PM for balance of assignment.

### RING ONE

**JUDGE: Dr. Jerry Sulewski**

#### 11:00 AM

#### Specialty

- 5 Keeshonden Sweepstakes (3-2)
- 5 Keeshonden Veteran Sweepstakes (3-2)
- 10 Total Dogs

### RING ONE

**JUDGE: Mr. Richard Lashbrook**

**Continuation of assignment from Ring 8 at 9:45 AM**

#### 11:30 AM

#### Specialty

- 10 Chinese Shar-Pei 1-4-(1-4)
- 20 Keeshonden 5-6-(4-3)-2

### 12:45 PM

- 1 \*Bichons Frises 0-1-(0-0)
- 1 Schipperkes 1-0-(0-0)
- 1 Tibetan Spaniels 0-0-(1-0)
- 2 Tibetan Terriers 0-0-(0-2)
- 5 American Eskimo Dogs 1-1-(1-1)-1
- 5 Lhasa Apsos 0-2-(0-2)-1
- 12 Shiba Inu 4-4-(2-2)
- 16 Danish-Swedish Farmdogs 3-7-(3-3)

137 Total Dogs

### CONCURRENT SHOW Western Boston Terrier Club, Inc.

### RING ONE

**JUDGE: Ms. Rita J. Biddle, Esq.**

#### 2:30 PM

#### Junior Showmanship Competition

- 2 Open
- 1 Master
- Best Junior Handler

#### Specialty

- 27 Boston Terriers 6-10-(5-3)-3
- 30 Total Dogs

## SATURDAY

### RING TWO

JUDGE: Ms. Patricia Proctor

#### 8:00 AM

- 3 Miniature Pinschers 0-0-(1-2)
- 3 Toy Fox Terriers 1-0-(0-2)
- 11 Pugs 1-7-(2-1)
- 9 Chinese Cresteds 1-4-(3-1)

#### 9:00 AM

- 1 Affenpinschers 1-0-(0-0)
- 1 English Toy Spaniels (KC & R) 0-0-(1-0)
- 2 Pekingese 1-1-(0-0)
- 21 Pomeranians 7-6-(6-1)-1

#### 10:00 AM

- 1 Maltese 0-0-(0-1)
- 3 Silky Terriers 0-1-(1-1)
- 8 Biewer Terriers 3-3-(1-1)
- 13 Papillons 3-3-(5-2)

See 12:15 PM for balance of assignment.

### RING TWO

JUDGE: Mr. David L. Kittredge

Continuation of assignment from Ring 4 at 9:30 AM

#### 11:00 AM

- 9 \*Scottish Terriers 1-2-(0-6)
- Specialty
- 17 Shih Tzu 3-6-(4-4)

See Ring 4 at 1:00 PM for balance of assignment.

### RING TWO

JUDGE: Ms. Patricia Proctor

Continuation of assignment from Ring 2 at 11:00 AM

#### 12:15 PM

- 5 Russian Toys 0-0-(2-3)
  - 5 Yorkshire Terriers 1-3-(1-0)
  - 20 Cavalier King Charles Spaniels 7-5-(5-2)-1
- 106 Total Dogs

### RING THREE

JUDGE: Mrs. Bergit Coady-Kabel

#### 8:00 AM

- 2 American Hairless Terriers 1-0-(1-0)
- 2 Australian Terriers 0-2-(0-0)
- 2 Russell Terriers 0-1-(1-0)
- 2 Norwich Terriers 0-0-(1-1)
- 3 Norfolk Terriers 0-0-(0-3)
- 7 Cairn Terriers 4-2-(1-0)
- 3 Glen of Imaal Terriers 1-0-(1-1)
- 4 West Highland White Terriers 0-3-(1-0)
- 8 Bedlington Terriers 4-2-(1-1)

See Ring 6 at 9:30 AM for continuation of assignment.

### RING THREE

JUDGE: Ms. Linda George

#### 9:15 AM

- Specialty
- 21 Chihuahuas (Smooth Coat) 3-7-(7-2)-2
- Specialty
- 24 Chihuahuas (Long Coat) 6-9-(4-3)-2
- 45 Total Dogs

### RING THREE

JUDGE: Ms. Kathy L. Wilkins

Continuation of assignment from Ring 6 at 8:00 AM

#### 11:00 AM

- Specialty
- 27 Shetland Sheepdogs 9-14-(2-1)-1
- 43 Total Dogs

### RING THREE

JUDGE: Ms. Karen A. Dumke

Continuation of assignment from Ring 12 at 10:00 AM

#### 12:15 PM

- Specialty
- 1 \*Miniature Schnauzers 1-0-(0-0)

See Ring 11 at 12:30 PM for balance of assignment.

### RING THREE

JUDGE: Mr. Raymond V. Filburn, Jr.

Continuation of assignment from Ring 1 at 9:15 AM

(There will be a 5 minute break between Varieties)

#### 12:20 PM

- 2 Poodles (Toy) 1-0-(0-1)
  - 16 Poodles (Miniature) 2-9-(2-3)
  - 24 Poodles (Standard) 7-9-(7-1)
- 114 Total Dogs

### RING FOUR

JUDGE: Mr. David L. Kittredge

#### 8:00 AM

- 17 Retrievers (Flat-Coated) 5-5-(2-4)-1

#### 8:45 AM

- 2 Spaniels (Welsh Springer) 0-0-(1-1)
- 1 Spaniels (Cocker) Black 0-0-(0-1)
- 1 Spaniels (Cocker) A.S.C.O.B. 0-0-(1-0)
- 12 Spaniels (English Cocker) 2-5-(2-2)-1

#### 9:30 AM

- Specialty
- 32 Pointers (German Shorthaired) 5-13-(4-8)-2

See Ring 2 at 11:00 AM for continuation of assignment.

### RING FOUR

JUDGE: Ms. Leeann Podruch, DDS

#### 12:15 PM

- Specialty
- 13 Setters (English) Sweepstakes (6-7)
- 13 Total Dogs

### RING FOUR

JUDGE: Mr. David L. Kittredge

Continuation of assignment from Ring 2 at 11:00 AM

#### 1:00 PM

- Specialty
- 37 Setters (English) 11-11-(7-8)

# SATURDAY

**CONCURRENT SHOW**  
**Fox River Field Spaniel Club 4-6 Months Puppy**

**RING FOUR**  
**JUDGE: Mr. David L. Kittredge**

**2:30 PM**  
 1 Spaniels (Field)  
**Best 4-6 Month Puppy**

**CONCURRENT SHOW**  
**Fox River Field Spaniel Club**

**RING FOUR**  
**JUDGE: Mr. David L. Kittredge**

**2:35 PM**  
**Junior Showmanship Competition**  
 1 Novice Junior  
 2 Open Junior  
 4 Open Intermediate  
 4 Open Senior  
 1 Master  
 Best Junior Handler  
 Specialty  
 33 Spaniels (Field) 9-8-(8-5)-3  
 174 Total Dogs

**RING FIVE**  
**JUDGE: Mrs. Honey Anne Glendinning**

**8:00 AM**  
 Specialty  
 25 Wirehaired Pointing Griffons 2-10-(6-6)-1

**9:00 AM**  
 Specialty  
 19 Pointers (German Wirehaired) 4-5-(4-5)-1  
 33 Spaniels (Field) 9-8-(8-4)-4

**11:00 AM**  
 16 Spaniels (English Springer) 6-4-(0-4)-2

See 12:30 PM for continuation of assignment.

**RING FIVE**  
**JUDGE: Mrs. Betsey Orman**

**11:45 AM**  
 2 \*Polish Lowland Sheepdogs 0-0-(2-0)  
 7 \*Mudik 1-2-(2-2)  
 9 Total Dogs

**RING FIVE**  
**JUDGE: Mrs. Honey Anne Glendinning**

Continuation of assignment from Ring 5 at 11:45 AM

**12:30 PM**  
 Specialty  
 14 Berger Picards 1-8-(1-4)

See 1:45 PM for balance of assignment.

**CONCURRENT SHOW**  
**German Shorthaired Pointer Club of Wisconsin**

**RING FIVE**  
**JUDGE: Dr. Bree Ardizzone-Sulewski**

**1:00 PM**  
 Specialty  
 11 Pointers (German Shorthaired) Sweepstakes (5-6)  
 2 Pointers (German Shorthaired)  
 Veteran Sweepstakes (1-1)  
 13 Total Dogs

**RING FIVE**  
**JUDGE: Mrs. Honey Anne Glendinning**

Continuation of assignment from Ring 5 at 1:00 PM

**1:45 PM**  
**Junior Showmanship Competition**  
 3 Open Intermediate  
 1 Open Senior  
 2 Master  
 Best Junior Handler  
 Specialty  
 35 Pointers (German Shorthaired) 7-13-(5-9)-1  
 148 Total Dogs

**RING SIX**  
**JUDGE: Ms. Kathy L. Wilkins**

**8:00 AM**  
 7 \*Miniature American Shepherds 1-3-(2-1)  
 5 \*Border Collies 0-3-(1-1)  
 3 Collies (Smooth) 1-1-(1-0)  
 1 Collies (Rough) 0-0-(0-1)

See Ring 3 at 11:00 AM for balance of assignment.

**RING SIX**  
**JUDGE: Ms. Karen Coffey**

**8:45 AM**  
 Specialty  
 10 Airedale Terriers Sweepstakes (3-7)  
 2 Airedale Terriers Veteran Sweepstakes (1-1)  
 12 Total Dogs

**RING SIX**  
**JUDGE: Mrs. Bergit Coady-Kabel**

Continuation of assignment from Ring 3 at 8:00 AM

**9:30 AM**  
 Specialty  
 26 Airedale Terriers 5-10-(4-5)-2

**10:30 AM**  
 3 Kerry Blue Terriers 0-0-(1-2)  
 4 Irish Terriers 1-1-(1-1)  
 2 Lakeland Terriers 0-0-(0-2)

See Ring 14 at 1:00 PM for balance of assignment.

**RING SIX**  
**JUDGE: Mr. Mark Russo**

**11:00 AM**  
 Specialty  
 18 \*Pembroke Welsh Corgis 4-10-(2-1)-1  
 18 Total Dogs

# SATURDAY

## CONCURRENT SHOW

Waukesha Kennel Club, Inc. 4-6 Months Puppy

### RING SIX

JUDGE: Mrs. Kalen M. Dumke Voogt

Continuation of assignment from Ring 14 at 10:45 AM

12:30 PM

- 4 Bernese Mountain Dogs
- 2 Danish-Swedish Farmdogs
- 1 Doberman Pinschers
- 2 Great Danes
- 1 Leonbergers
- 1 Samoyeds

#### 4-6 Month Puppy Working Group

- 1 Airedale Terriers
- 1 American Hairless Terriers
- 1 Border Terriers
- 2 Lakeland Terriers
- 2 Miniature Bull Terriers
- 1 Norfolk Terriers
- 2 Soft Coated Wheaten Terriers

#### 4-6 Month Puppy Terrier Group

1:30 PM

- 1 Pointers (German Shorthaired)
- 1 Retrievers (Golden)
- 2 Retrievers (Labrador)
- 1 Setters (English)
- 1 Setters (Gordon)
- 1 Spaniels (Field)

#### 4-6 Month Puppy Sporting Group

- 1 German Shepherd Dogs
- 1 Mudik
- 1 Pembroke Welsh Corgis
- 2 Shetland Sheepdogs

#### 4-6 Month Puppy Herding Group

- 1 Dachshunds (Smooth)
- 1 Whippets

#### 4-6 Month Puppy Hound Group

- 1 Dalmatians
- 1 French Bulldogs

#### 4-6 Month Puppy Non-Sporting Group

- 3 Chihuahuas (Long Coat)
- 1 English Toy Spaniels (Blenheim & Prince Charles)
- 1 Pomeranians

#### 4-6 Month Puppy Toy Group

#### Best 4-6 Month Puppy in Show

107 Total Dogs

### RING SEVEN

JUDGE: Mrs. Christine E. Calcinari

8:00 AM

- 2 Xoloitzcuintli 0-0-(2-0)
- 13 Retrievers (Labrador) 3-9-(0-1)
- 14 Setters (Gordon) 3-7-(1-3)
- 10 Spaniels (Cumber) 2-2-(3-3)

9:30 AM

- 1 Spaniels (American Water) 0-0-(1-0)
- 6 Dalmatians 1-1-(2-2)
- 7 Setters (Irish Red and White) 1-0-(3-3)

See 10:30 AM for balance of assignment.

### RING SEVEN

JUDGE: Ms. Joyce B. Winkels

10:00 AM

Specialty

- 6 Setters (Irish) Sweepstakes (2-4)
- 2 Setters (Irish) Veteran Sweepstakes (1-1)
- 8 Total Dogs

### RING SEVEN

JUDGE: Mrs. Christine E. Calcinari

Continuation of assignment from 9:30 AM

10:30 AM

Specialty

- 32 Setters (Irish) 7-11-(6-6)-2

11:45 AM

Lunch

12:30 PM

- 36 Retrievers (Golden) 12-20-(1-3)
- 121 Total Dogs

### RING EIGHT

JUDGE: Mr. Richard Lashbrook

8:00 AM

Specialty

- 40 Great Danes 10-14-(10-5)-1

9:45 AM

Specialty

- 24 Spanish Water Dogs 3-5-(7-6)-3

See Ring 1 at 11:30 AM for balance of assignment.

### RING EIGHT

JUDGE: Mr. Leonardo Saldana

11:00 AM

- 16 Cardigan Welsh Corgis Sweepstakes (6-10)
- 3 Cardigan Welsh Corgis Veteran Sweepstakes (0-3)

19 Total Dogs

### RING EIGHT

JUDGE: Mrs. Janet Bodin

12:00 NOON

- 41 Cardigan Welsh Corgis 11-18-(5-5)-2
- 41 Total Dogs

### RING NINE

JUDGE: Mrs. Jo Ann Pavey

8:00 AM

- 4 Greater Swiss Mountain Dogs 0-0-(1-2)-1
- 4 Finnish Lapphunds 1-2-(0-1)

Specialty

- 61 Doberman Pinschers 17-26-(8-10)

10:45 AM

- 37 Australian Shepherds 11-15-(7-2)-2
- 2 Old English Sheepdogs 1-0-(0-1)

12:15 PM

Lunch

## SATURDAY

### 1:00 PM

- 1 Boerboels 1-0-(0-0)
- 1 Beaucerons 0-0-(1-0)
- 6 Cane Corsos 2-3-(1-0)
- 3 Briards 0-0-(3-0)
- 1 Pyrenean Shepherds 0-0-(0-1)
- 6 Icelandic Sheepdogs 3-1-(0-1)-1
- 10 Australian Cattle Dogs 5-2-(2-1)
- 5 Swedish Vallhunds 2-0-(1-2)

141 Total Dogs

### RING TEN

JUDGE: Ms. Joyce Siddall

### 8:00 AM

- 11 Rottweilers 2-4-(3-2)
- 11 Boxers 4-2-(2-3)

### 9:00 AM

- 26 Alaskan Malamutes 7-7-(7-5)

See 1:30 PM for balance of assignment.

### RING TEN

JUDGE: Mr. Richard (Rick) Orlowski

### 10:00 AM

- 9 \*Belgian Tervuren 2-2-(3-2)
- Specialty
- 24 German Shepherd Dogs 7-13-(0-4)
- 33 Total Dogs

### CONCURRENT SHOW Shoreline German Shepherd Dog Club

### RING TEN

JUDGE: Mr. Joseph Beccia

### 12:30 PM

- Specialty
- 22 \*German Shepherd Dogs 9-9-(0-4)
- 22 Total Dogs

### CONCURRENT SHOW Doberman Pinscher Club of Greater Milwaukee

### RING TEN

JUDGE: Ms. Joyce Siddall

Continuation of assignment from 9:00 AM

### 1:30 PM

### Junior Showmanship Competition

- 3 Open
- 1 Master
- Best Junior Handler
- Specialty
- 63 Doberman Pinschers 16-28-(9-10)
- 115 Total Dogs

### RING ELEVEN

JUDGE: Mrs. Linda Clark

### 8:00 AM

- 9 Retrievers (Chesapeake Bay) 3-2-(1-1)-2
- 10 Retrievers (Curly-Coated) 1-4-(2-2)-1
- 7 Weimaraners 1-2-(3-1)

### 9:00 AM

- 10 Belgian Malinois 1-2-(2-4)-1
- 16 Ret (Nova Scotia Duck Tolling) 4-7-(3-2)

### 10:00 AM

- 3 \*Nederlandse Kooikerhondjes 1-2-(0-0)
- 1 \*Lagotti Romagnoli 1-0-(0-0)
- 2 \*Spaniels (Boykin) 0-0-(1-1)
- 1 \*Spinoni Italiani 1-0-(0-0)
- 2 \*Spaniels (Irish Water) 0-1-(0-1)
- 4 \*Bracchi Italiani 0-0-(1-2)-1
- 1 Belgian Laekenois 0-0-(0-1)
- 1 Belgian Sheepdogs 0-1-(0-0)
- 1 Canaan Dogs 0-0-(0-1)
- 2 Pointers 0-0-(2-0)
- 6 Bearded Collies 2-4-(0-0)
- 11 Brittany 2-0-(3-6)

See Ring 15 at 1:00 PM for balance of assignment.

### RING ELEVEN

JUDGE: Mrs. Angie Hartley

### 12:15 PM

- 4 Rhodesian Ridgebacks Sweepstakes (3-1)
- 1 Rhodesian Ridgebacks Veteran Sweepstakes (1-0)
- 5 Total Dogs

### RING ELEVEN

JUDGE: Ms. Karen A. Dumke

Continuation of assignment from Ring 3 at 12:15 PM

### 12:30 PM

- 23 Rhodesian Ridgebacks 3-6-(10-2)-2
- 94 Total Dogs

### RING TWELVE

JUDGE: Ms. Karen A. Dumke

### 8:00 AM

- 2 Teddy Roosevelt Terriers 1-1-(0-0)
- 1 German Spitz 0-1-(0-0)
- 2 Yakutian Laikas 2-0-(0-0)
- Best in Miscellaneous Class
- 1 Portuguese Podengo Pequenos 0-0-(1-0)
- 3 Beagles, 15 Inch 1-1-(1-0)
- 1 Greyhounds 0-0-(1-0)
- 1 Redbone Coonhounds 0-0-(1-0)
- 2 Harriers 1-0-(1-0)
- 3 Irish Wolfhounds 1-2-(0-0)
- 9 Scottish Deerhounds 0-5-(1-3)

### 9:00 AM

- 2 Beagles, 13 Inch 0-1-(0-1)
- 22 Borzois 3-9-(5-5)

### 10:00 AM

- Specialty
- 21 Basenjis 4-7-(5-5)

See Ring 3 at 12:15 PM for continuation of assignment.

## SATURDAY

### RING TWELVE

**JUDGE: Mrs. Abigail (Abby) S. Patrizio**

Continuation of assignment from Ring 15 at 12:00 NOON

#### 1:15 PM

- 1 Kuvaszok 0-0-(1-0)
- 7 Akitas 2-1-(2-2)
- 11 Samoyeds 2-5-(3-1)
- 11 Siberian Huskies 2-4-(4-1)

133 Total Dogs

### RING THIRTEEN

**JUDGE: Mr. Harold "Red" Tatro, III**

#### 9:00 AM

- 12 Basset Hounds 1-7-(1-3)
- 2 Treeing Walker Coonhounds 0-0-(2-0)
- 6 Dachshunds (Smooth) 1-4-(1-0)
- 7 Dachshunds (Wirehaired) 3-1-(3-0)
- 10 Dachshunds (Longhaired) 1-2-(2-5)

#### 10:30 AM

- 1 Petits Bassets Griffons Vendeens 0-0-(0-1)
- 1 American English Coonhounds 0-0-(1-0)
- 3 Otterhounds 1-0-(2-0)
- 3 Salukis 0-1-(2-0)
- 3 Afghan Hounds 1-0-(2-0)
- 3 Norwegian Elkhounds 0-1-(1-1)

See 11:45 AM for balance of assignment.

### RING THIRTEEN

**JUDGE: Ms. Karrie Dollar**

#### 11:00 AM

- 11 Whippets Sweepstakes (4-7)
- 11 Total Dogs

### RING THIRTEEN

**JUDGE: Mr. Harold "Red" Tatro, III**

Continuation of assignment from 10:30 AM

#### 11:45 AM

- 45 Whippets 15-16-(8-6)
- 96 Total Dogs

### RING FOURTEEN

**JUDGE: Mrs. Kalen M. Dumke Voogt**

#### 8:00 AM

##### Junior Showmanship Competition

- 9 Master
- 15 Open Senior
- 19 Open Intermediate
- 7 Open Junior
- 1 Novice Senior
- 2 Novice Intermediate
- 2 Novice Junior
- Best Junior Handler

#### 10:45 AM

##### Specialty

- 10 Soft Coated Wheaten Terriers 1-3-(1-5)

See Ring 6 at 12:30 PM for balance of assignment.

### RING FOURTEEN

**JUDGE: Mrs. Bergit Coady-Kabel**

Continuation of assignment from Ring 6 at 10:30 AM

#### 1:00 PM

- 2 Bull Terriers (White) 0-0-(1-1)
- 6 Bull Terriers (Colored) 0-5-(0-1)
- 1 Staffordshire Bull Terriers 0-0-(1-0)
- 7 American Staffordshire Terriers 2-1-(2-2)
- 5 Miniature Bull Terriers 2-0-(0-2)-1
- 5 Fox Terriers (Smooth) 1-0-(2-2)
- 11 Border Terriers 2-4-(3-2)

105 Total Dogs

### RING FIFTEEN

**JUDGE: Ms. Wanda Tait**

#### 8:00 AM

- 7 Bernese Mountain Dogs Sweepstakes (3-4)
- 2 Bernese Mountain Dogs Veteran Sweepstakes (0-2)

9 Total Dogs

### RING FIFTEEN

**JUDGE: Mrs. Abigail (Abby) S. Patrizio**

#### 8:30 AM

##### Specialty

- 38 Bernese Mountain Dogs 8-14-(13-2)-1

#### 10:00 AM

- 3 Newfoundlands 1-2-(0-0)
- 12 Bullmastiffs 1-8-(2-1)
- 11 Leonbergers 2-4-(2-3)

#### 11:00 AM

- 26 Portuguese Water Dogs 3-7-(9-6)-1

#### 12:00 NOON

- 2 Saint Bernards 0-0-(2-0)
- 6 Standard Schnauzers 2-1-(1-2)
- 5 Great Pyrenees 0-1-(2-2)

See Ring 12 at 1:15 PM for balance of assignment.

### RING FIFTEEN

**JUDGE: Mrs. Linda Clark**

Continuation of assignment from Ring 11 at 10:00 AM

#### 1:00 PM

- 21 Vizslas 6-6-(1-8)
- 108 Total Dogs

##### Obedience/Rally Contact:

**Donna Schmidt (920) 285-4842**

### RING SIXTEEN

**JUDGE: Mrs. Anna Lorenz**

**(Judge will take a 45 minute luncheon break at her discretion)**

#### 8:00 AM

- 13 Utility Class B & Preferred Utility Obedience Entries  
Nos P58 31 34 35 36 37 41 42 44 45 46 47 48

#### 9:55 AM

- 2 Utility Class A Obedience Entries  
Nos 50 51

#### 10:15 AM

- 1 Graduate Open Class Obedience Entries  
Nos 76

## SATURDAY

### 10:25 AM

- 2 Open Class A Obedience Entries  
Nos 26 29

### 10:40 AM

- 17 Open Class B & Preferred Open Obedience Entries  
Nos P56 P57 31 32 34 35 36 37 38 41 42 43  
44 45 46 47 48

### After Noon

- 3 Graduate Novice Class Obedience Entries  
Nos 10 73 75

### After Noon

- 10 Novice Class B Obedience Entries  
Nos 8 9 10 11 14 15 16 17 20 23

### After Noon

**A combined 5 minute walk-thru prior to the start of Novice Class A & the Preferred Novice Class will be allowed for handlers without their dogs**  
Class to follow

- 2 Novice Class A Obedience Entries  
Nos 5 6  
2 Preferred Novice Class Obedience Entries  
Nos P53 P54

### After Noon

**A combined 10 minute walk-thru prior to the start of the Beginner Novice Classes will be allowed for handlers without their dogs**  
Class to follow

- 4 Beginner Novice Class A Obedience Entries  
Nos 59 60 62 63  
8 Beginner Novice Class B Obedience Entries  
Nos 64 66 67 68 69 70 71 72

### After Noon

- 2 Veterans Class Obedience Entries  
Nos 78 79

## RING SEVENTEEN

**JUDGE: Mr. James Comunale**

**(Judge will take a 45 minute luncheon break at his discretion)**

### 8:00 AM

- Rally Choice Class Walk Thru**  
Class to Follow  
2 Rally Choice Class  
Nos 62 124

### 8:20 AM

- Rally Master Class Walk Thru**  
Class to Follow

- 21 Rally Master Class  
Nos 61 62 63 64 65 117 73 120 60 77 78 79  
80 81 89 90 91 95 100 124 126

### 9:35 AM

- Rally Excellent Class A Walk Thru**  
Class to Follow

- 1 Rally Excellent Class A  
Nos 107

### 9:50 AM

- Rally Excellent Class B Walk Thru**  
Class to Follow

- 25 Rally Excellent Class B  
Nos 61 63 64 65 66 73 110 111 112 60 75  
77 78 79 80 81 82 89 90 91 95 98 100 113  
114

### 11:15 AM

- Rally Advanced Class A Walk Thru**  
Class to Follow

- 2 Rally Advanced Class A  
Nos 57 58

### 11:35 AM

- Rally Advanced Class B Walk Thru**  
Class to Follow

- 28 Rally Advanced Class B  
Nos 61 63 64 65 66 69 73 74 60 75 76 77  
78 79 80 81 82 85 86 89 90 91 94 95 97 98  
100 103

### After Noon

- Rally Intermediate Class Walk Thru**  
Class to Follow

- 9 Rally Intermediate Class  
Nos 46 47 48 49 50 51 52 54 55

### After Noon

- Rally Novice Class A Walk Thru**  
Class to Follow

- 13 Rally Novice Class A  
Nos 5 6 7 8 9 10 11 12 15 16 17 18 21

### After Noon

- Rally Novice Class B Walk Thru**  
Class to Follow

- 18 Rally Novice Class B  
Nos 22 23 24 25 26 29 30 31 32 34 35 36  
37 38 39 40 41 42

## RING TWELVE

### 3:15 PM Variety Groups and Best in Show

(The groups will be judged in the following order unless otherwise announced)

Hound.....	Mr. Harold "Red" Tatro, III
Toy.....	Ms. Patricia Proctor
Herding.....	Mrs. Jo Ann Pavey
Terrier.....	Mrs. Bergit Coady-Kabel
Non-Sporting.....	Mr. Raymond V. Filburn, Jr.
Sporting.....	Mrs. Honey Anne Glendinning
Working.....	Mrs. Abigail (Abby) S. Patrizio
Best in Show.....	Mr. David L. Kittredge

## *Best Bred by Exhibitor in Show Special Attraction Competition Saturday Only*

DOGS ELIGIBLE TO COMPETE FOR BEST BRED BY EXHIBITOR IN BREED ARE LIMITED TO THE FIRST PLACE WINNER FROM THE REGULAR BRED BY EXHIBITOR, 6 & UNDER 12 MONTHS & BRED BY EXHIBITOR, 12 MONTHS & OVER CLASSES.

Best Bred by Exhibitor judged immediately following Best of Breed. If Best of Breed or Best of Winners is awarded to a class dog/bitch eligible for Bred by Exhibitor, the Best Bred by Exhibitor win is automatic.

Bred-by Exhibitor Group judges will be posted at Superintendent table at the Show.

**SATURDAY  
RING FOURTEEN**

**2:45 PM Owner-Handled Variety Groups and Best Owner-Handled in Show**

Owner-Handled Hound.....	Ms. Karen A. Dumke
Owner-Handled Toy .....	Ms. Kathy L. Wilkins
Owner-Handled Herding.....	Mr. Mark Russo
Owner-Handled Terrier .....	Ms. Karen A. Dumke
Owner-Handled Non-Sporting.....	Mrs. Christine E. Calcinari
Owner-Handled Sporting.....	Mrs. Linda Clark
Owner-Handled Working .....	Mr. Richard Lashbrook
Best Owner-Handled in Show .....	Mrs. Kalen M. Dumke Voigt

**RING NINE**

**2:30 PM Bred by Exhibitor Variety Groups and Best Bred by Exhibitor in Show**

Bred By Exhibitor Hound .....	To Be Announced
Bred By Exhibitor Toy .....	To Be Announced
Bred By Exhibitor Herding .....	To Be Announced
Bred By Exhibitor Terrier.....	To Be Announced
Bred By Exhibitor Non-Sporting .....	To Be Announced
Bred By Exhibitor Sporting .....	To Be Announced
Bred By Exhibitor Working.....	To Be Announced
Best Bred By Exhibitor in Show .....	To Be Announced

**RING ELEVEN**

**2:30 PM Veteran Variety Groups and Best Veteran in Show**

Veteran Hound.....	To Be Announced
Veteran Toy .....	To Be Announced
Veteran Herding.....	To Be Announced
Veteran Terrier .....	To Be Announced
Veteran Non Sporting .....	To Be Announced
Veteran Sporting.....	To Be Announced
Veteran Working .....	To Be Announced
Best Veteran in Show.....	To Be Announced

## **AKC National Owner-Handled Series**



The AKC National Owner-Handled Series is a non-titling competition for dogs that are exhibited by their owners that are not professional handlers.

Exhibitors must declare their dog is Owner-Handled eligible at the time of entry on the entry form.

Dogs entered in the Amateur-Owner-Handler class will automatically be marked as eligible to compete in the NOHS.

Eligible dogs will be identified by an asterisk in the judge's book, steward's book & the catalog. Dogs must be handled throughout the breed level competition for the regular show by an eligible owner.

Professional handlers\*, household members and current assistants\*\* to professional handlers may not exhibit the dog in any NOHS competition during the entire show. For a detailed description of the National Owner-Handled Series, please visit the AKC website NOHS pages at:

<https://www.akc.org/sports/conformation/national-owner-handled-series/>

*\*Professional handlers are defined as any person who belongs or has belonged to a professional handlers' organization, distributed rate cards, or otherwise advertised or represented themselves as handling dogs for pay within the last five years.*

*\*\*A current assistant is defined as anyone employed by a professional handler on a full-time basis or assisting a professional handler at the show or any time during the cluster/weekend. Current assistants that are eligible to compete in Junior Showmanship (meet age & amateur status requirements) may participate in NOHS.*

## **Best Veteran in Show Special Attraction Competition Saturday Only**

WKC offers two Veteran classes - Non-Regular Veteran class for INTACT Veterans, judged prior to Best of Breed, offered both days. Saturday only - Special Attraction Veteran class open to altered exhibits. INTACT Veterans compete for Best of Breed/Variety. The winner of INTACT Veteran is automatically eligible to compete in the Veteran Special Attraction.

Saturday only - Exhibitors may enter intact or ALTERED dogs directly in the Veteran Special Attraction - competition held after Best of Breed judging.

The Special Attraction competition will include the winners of the Intact Non-Regular Veteran Classes and any directly entered dogs. Veteran Group Judges will be posted at the Superintendent table at the show.

## PROGRAM OF JUDGING - SUNDAY - JULY 27, 2025

There are 1607 dogs in this show & trials with a total entry of 1662 in 170 different Breeds or Varieties, including 52 obedience entries and 67 dogs and 97 rally entries. and 33 4-6 Puppy entries. For your convenience, the following division of sexes has been carefully tabulated; however, neither the Club nor the Superintendent or Show Secretary assumes responsibility for absolute accuracy.

In accordance with Chapter 7, Section 8, of "Rules Applying to Dog Shows" and with American Kennel Club Approval the following changes apply:

<u>Breed</u>	<u>Original Judge</u>	<u>New Judge</u>
Standard Schnauzers	Ms. Rita J. Biddle, Esq.	Ms. Joyce Siddall
Dalmatians	Ms. Rita J. Biddle, Esq.	Mr. Richard Lashbrook
Xoloitzcuintli	Ms. Rita J. Biddle, Esq.	Mr. Richard Lashbrook
Owner-Handled Working Group	Ms. Rita J. Biddle, Esq.	Mrs. Jo Ann Pavey

With American Kennel Club Approval the following change applies:

<u>Breed</u>	<u>Original Judge</u>	<u>New Judge</u>
Entire 4-6 Month Puppy Assignment	Ms. Kathy L. Wilkins	Mr. Mark Russo

The number before each Breed (Variety) indicates the number of dogs entered in that Breed (Variety). The numbers following each Breed (Variety) indicate the number of Regular Class Dogs, Regular Class Bitches, Best of Breed (Variety) (Dogs-Bitches), and Non-Regular Class Dogs or Bitches.

### RING ONE

**JUDGE: Mr. David L. Kittredge**

#### 8:00 AM

- 18 French Bulldogs 7-7-(2-2)
- 8 Chinese Cresteds 1-3-(3-1)

#### 9:00 AM

- 1 Tibetan Spaniels 0-0-(1-0)
- 2 Tibetan Terriers 0-0-(0-2)
- 5 American Eskimo Dogs 1-1-(1-1)-1
- 6 Norwegian Lundehunds 1-3-(1-1)
- 11 Shiba Inu 4-3-(2-2)

#### 10:00 AM

- 1 Schipperkes 1-0-(0-0)

#### Specialty

- 24 Boston Terriers 6-11-(4-3)

#### 11:00 AM

- 10 Chinese Shar-Pei 1-4-(1-4)
- 16 Keeshonden 6-5-(3-1)-1

#### 12:00 NOON

- 1 Cotons de Tulear 0-0-(0-1)
- 1 Lowchen 0-0-(1-0)
- 4 Lhasa Apsos 0-2-(0-2)

108 Total Dogs

### RING ONE

**JUDGE: Ms. Cynthia L. Pagurski**

**Continuation of assignment from Ring 13 at 8:00 AM**

#### 12:15 PM

- 1 Bulldogs 0-0-(1-0)
- 2 \*Chow Chows 0-0-(2-0)
- 1 Bichons Frises 0-1-(0-0)
- 9 \*Pugs 1-5-(2-1)
- 7 \*Brussels Griffons 1-3-(3-0)
- 7 Havanese 3-2-(2-0)

50 Total Dogs

### RING TWO

**JUDGE: Mr. Raymond V. Filburn, Jr.**

#### 8:00 AM

- 8 Biewer Terriers 3-3-(1-1)

#### Specialty

- 18 Chihuahuas (Smooth Coat) 3-7-(6-2)

### 9:00 AM

#### Specialty

- 22 Chihuahuas (Long Coat) 5-10-(3-3)-1
- 2 Pekingese 1-1-(0-0)
- 1 English Toy Spaniels (KC & R) 0-0-(1-0)

### 10:00 AM

#### Specialty

- 18 Shih Tzu 5-6-(3-4)

See 12:45 PM for balance of assignment.

### RING TWO

**JUDGE: Ms. Linda George**

### 10:45 AM

- 12 Papillons 3-2-(5-2)
- 19 Pomeranians 6-5-(6-1)-1
- 17 \*Cavalier King Charles Spaniels 7-4-(4-2)

48 Total Dogs

### RING TWO

**JUDGE: Mr. Raymond V. Filburn, Jr.**

**Continuation of assignment from Ring 2 at 10:45 AM**

### 12:45 PM

- 1 Affenpinschers 1-0-(0-0)
- 1 Manchester Terriers (Toy) 0-0-(1-0)
- 3 Toy Fox Terriers 1-0-(0-2)
- 1 Maltese 0-0-(0-1)
- 2 Silky Terriers 0-0-(1-1)
- 4 Miniature Pinschers 0-0-(2-2)
- 6 Russian Toys 1-0-(1-4)
- 5 Yorkshire Terriers 1-3-(1-0)

92 Total Dogs

## SUNDAY

### RING THREE

**JUDGE: Mr. Harold "Red" Tatro, III**

#### 8:00 AM

- 2 American Hairless Terriers 1-0-(1-0)
- 2 Australian Terriers 0-2-(0-0)
- 2 Russell Terriers 0-1-(1-0)
- 2 Norwich Terriers 0-0-(1-1)
- 3 Norfolk Terriers 0-0-(0-3)
- 7 Cairn Terriers 4-2-(1-0)
- 7 Bedlington Terriers 3-2-(1-1)

#### 9:00 AM

- 3 Glen of Imaal Terriers 1-0-(1-1)
- 5 West Highland White Terriers 0-4-(1-0)
- 9 Scottish Terriers 1-2-(0-6)

#### Specialty

- 1 Miniature Schnauzers 1-0-(0-0)

See Ring 6 at 10:00 AM for continuation of assignment.

### RING THREE

**JUDGE: Mrs. Jo Ann Pavey**

**Continuation of assignment from Ring 10 at 8:00 AM**

#### 9:45 AM

#### Specialty

- 29 Shetland Sheepdogs 9-16-(2-1)-1

See Ring 6 at 12:00 NOON for balance of assignment.

### RING THREE

**JUDGE: Ms. Rita J. Biddle, Esq.**

**Continuation of assignment from Ring 8 at 8:00 AM**

**(There will be a 5 minute break between Varieties)**

#### 11:30 AM

- 3 Poodles (Toy) 1-1-(0-1)
- 14 Poodles (Miniature) 3-7-(1-3)
- 21 Poodles (Standard) 6-9-(5-1)

80 Total Dogs

### RING FOUR

**JUDGE: Ms. Nancy E. Talbott**

#### 8:00 AM

- 25 \*Wirehaired Pointing Griffons 3-10-(6-6)

#### 9:15 AM

- 1 Spaniels (American Water) 0-0-(1-0)

#### Specialty

- 29 Spaniels (Field) 8-9-(7-4)-1
- 9 Retrievers (Chesapeake Bay) 4-2-(1-1)-1

#### Specialty

- 11 Pointers (German Wirehaired) 3-2-(2-3)-1

#### 11:15 AM

Lunch

#### 12:00 NOON

- 16 Retrievers (Labrador) 4-11-(0-1)
- 33 Retrievers (Golden) 10-19-(1-3)

124 Total Dogs

### RING FIVE

**JUDGE: Mrs. Christine E. Calcinari**

#### 8:00 AM

- 3 Nederlandse Kooikerhondjes 1-2-(0-0)
- 11 Retrievers (Curly-Coated) 1-4-(3-2)-1
- 18 Retrievers (Flat-Coated) 5-6-(3-4)

#### 9:15 AM

- 4 Bracchi Italiani 0-0-(2-2)
- 4 Miniature Bull Terriers 2-0-(0-2)
- 1 Staffordshire Bull Terriers 0-0-(1-0)
- 7 American Staffordshire Terriers 2-1-(2-2)
- 1 Lagotti Romagnoli 1-0-(0-0)
- 1 Spaniels (Boykin) 0-0-(0-1)
- 2 Spaniels (Welsh Springer) 0-0-(1-1)
- 4 Irish Terriers 1-1-(1-1)
- 15 Spaniels (English Springer) 6-4-(1-4)

#### 10:45 AM

- 1 Spinoni Italiani 1-0-(0-0)
- 1 Bull Terriers (Colored) 0-0-(0-1)
- 2 Bull Terriers (White) 0-0-(1-1)
- 2 Pointers 0-0-(2-0)
- 8 Weimaraners 1-3-(3-1)
- 1 Spaniels (Cocker) Black 0-0-(0-1)
- 9 Border Terriers 2-3-(3-1)
- 1 Spaniels (Cocker) A.S.C.O.B. 0-0-(1-0)

#### 11:45 AM

Lunch

#### 12:30 PM

- 2 Spaniels (Irish Water) 0-1-(0-1)
- 16 Spaniels (English Cocker) 4-7-(2-2)-1

#### 1:15 PM

- 15 Ret (Nova Scotia Duck Tolling) 4-5-(4-2)
- 20 Vizslas 6-4-(1-9)

149 Total Dogs

### RING SIX

**JUDGE: Ms. Patricia K. Gregg**

#### 9:30 AM

#### Specialty

- 7 Airedale Terriers Sweepstakes (2-5)
- 1 Airedale Terriers Veteran Sweepstakes (0-1)

8 Total Dogs

### RING SIX

**JUDGE: Mr. Harold "Red" Tatro, III**

**Continuation of assignment from Ring 3 at 9:00 AM**

#### 10:00 AM

- 3 Kerry Blue Terriers 0-0-(1-2)

#### Specialty

- 25 Airedale Terriers 5-10-(4-5)-1

See Ring 14 at 11:30 AM for continuation of assignment.

### RING SIX

**JUDGE: Mrs. Jo Ann Pavey**

**Continuation of assignment from Ring 3 at 9:45 AM**

#### 12:00 NOON

- 30 Pointers (German Shorthaired) 5-12-(5-7)-1
- 2 Collies (Smooth) 0-1-(1-0)
- 3 Otterhounds 1-0-(2-0)
- 3 Salukis 0-1-(2-0)
- 1 Collies (Rough) 0-0-(0-1)
- 3 Norwegian Elkhounds 0-1-(1-1)
- 1 Petits Bassets Griffons Vendeens 0-0-(0-1)

109 Total Dogs

## SUNDAY

### RING SEVEN

**JUDGE: Mrs. Linda Clark**

**8:00 AM**

#### Junior Showmanship Competition

- 9 Master
- 15 Open Senior
- 17 Open Intermediate
- 8 Open Junior
- 1 Novice Senior
- 2 Novice Intermediate
- 2 Novice Junior
- Best Junior Handler

**10:45 AM**

#### Specialty

- 22 Spanish Water Dogs 3-5-(7-6)-1

See Ring 10 at 12:30 PM for balance of assignment.

### RING SEVEN

**JUDGE: Mrs. Honey Anne Glendinning**

**Continuation of assignment from Ring 15 at 10:20 AM**

**11:45 AM**

- 1 \*Portuguese Podengo Pequenos 0-0-(1-0)
- 30 Setters (Irish) 5-9-(9-6)-1

**1:00 PM**

Lunch

**1:45 PM**

- 7 Setters (Irish Red and White) 1-0-(3-3)
- 11 Brittany 1-0-(3-7)

140 Total Dogs

### RING EIGHT

**JUDGE: Ms. Rita J. Biddle, Esq.**

**8:00 AM**

#### Specialty

- 42 Great Danes 11-16-(9-6)

See Ring 3 at 11:30 AM for balance of assignment.

### RING EIGHT

**JUDGE: Mr. Harold "Red" Tatro, III**

**Continuation of assignment from Ring 14 at 11:30 AM**

**12:45 PM**

- 2 Lakeland Terriers 0-0-(0-2)
- 5 Fox Terriers (Smooth) 1-0-(2-2)
- 13 Basenjis 3-5-(5-0)

101 Total Dogs

### RING NINE

**JUDGE: Mr. Richard Lashbrook**

**8:00 AM**

- 3 Greater Swiss Mountain Dogs 0-0-(1-2)

#### Specialty

- 58 Doberman Pinschers 16-26-(6-10)

**10:30 AM**

- 7 Akitas 2-1-(2-2)
- 11 Rottweilers 2-4-(2-3)
- 6 Dalmatians 1-1-(2-2)
- 8 Belgian Malinois 0-2-(2-4)

**11:45 AM**

Lunch

**12:30 PM**

- 2 Xoloitzcuintli 0-0-(2-0)
- 1 Pyrenean Shepherds 0-0-(0-1)
- 2 Polish Lowland Sheepdogs 0-0-(2-0)
- 3 Swedish Vallhunds 0-0-(1-2)
- 1 Beaucerons 0-0-(1-0)
- 1 Belgian Laekenois 0-0-(0-1)
- 1 Belgian Sheepdogs 0-0-(1-0)
- 1 Canaan Dogs 0-0-(0-1)
- 2 Bearded Collies 2-0-(0-0)
- 3 Briards 0-0-(3-0)
- 5 Border Collies 0-3-(1-1)
- 8 Belgian Tervuren 2-2-(2-2)
- 2 Teddy Roosevelt Terriers 1-1-(0-0)
- 1 German Spitz 0-1-(0-0)
- 2 Yakutian Laikas 2-0-(0-0)
- Best in Miscellaneous Class

128 Total Dogs

### RING TEN

**JUDGE: Mrs. Jo Ann Pavey**

**8:00 AM**

- 20 Alaskan Malamutes 5-5-(6-4)

#### Specialty

- 17 Pembroke Welsh Corgis 4-10-(2-1)

See Ring 3 at 9:45 AM for continuation of assignment.

### RING TEN

**JUDGE: Mrs. Linda Clark**

**Continuation of assignment from Ring 7 at 10:45 AM**

**12:30 PM**

#### Specialty

- 27 German Shepherd Dogs 8-15-(0-4)
- 23 Rhodesian Ridgebacks 3-7-(10-2)-1

126 Total Dogs

### RING ELEVEN

**JUDGE: Ms. Joyce Siddall**

**8:00 AM**

- 10 Bullmastiffs 1-6-(2-1)
- 6 Cane Corsos 2-3-(1-0)
- 9 Leonbergers 2-2-(2-3)
- 3 Newfoundlands 1-2-(0-0)
- 2 \*Saint Bernards 0-0-(2-0)
- 5 Great Pyrenees 0-1-(2-2)
- 1 Boerboels 1-0-(0-0)
- 1 Kuvaszok 0-0-(1-0)

**9:30 AM**

- 37 Australian Shepherds 10-16-(7-3)-1

**11:00 AM**

- 24 Portuguese Water Dogs 3-5-(9-6)-1
- 4 \*Finnish Lapphunds 1-2-(0-1)
- 7 \*Mudik 1-2-(2-2)

**12:30 PM**

Lunch

**1:15 PM**

- 6 Standard Schnauzers 2-1-(1-2)
- 5 \*Icelandic Sheepdogs 3-1-(0-1)
- 11 Samoyeds 2-5-(3-1)
- 7 Miniature American Shepherds 1-3-(2-1)
- 15 \*Danish-Swedish Farmdogs 3-6-(2-4)

153 Total Dogs

## SUNDAY

### RING TWELVE

**JUDGE: Mrs. Kalen M. Dumke Voogt**

#### 8:00 AM

- 12 Basset Hounds 1-7-(1-3)
- 6 Dachshunds (Smooth) 1-4-(1-0)
- 6 Dachshunds (Wirehaired) 3-1-(2-0)
- 14 Dachshunds (Longhaired) 2-3-(3-6)

#### 9:30 AM

- 3 Afghan Hounds 1-0-(2-0)
- 24 Borzois 4-9-(5-6)

#### 10:30 AM

- 42 Whippets 12-16-(8-6)

#### 12:15 PM

Lunch

#### 1:00 PM

- 2 Beagles, 13 Inch 0-1-(0-1)
- 3 Beagles, 15 Inch 1-1-(1-0)
- 1 Greyhounds 0-0-(1-0)
- 1 Redbone Coonhounds 0-0-(1-0)
- 1 Treeing Walker Coonhounds 0-0-(1-0)
- 2 Harriers 1-0-(1-0)
- 4 Irish Wolfhounds 1-3-(0-0)
- 9 Scottish Deerhounds 0-5-(1-3)

130 Total Dogs

### RING THIRTEEN

**JUDGE: Ms. Cynthia L. Pagurski**

#### 8:00 AM

- 11 \*Boxers 4-2-(2-3)
- 12 Siberian Huskies 2-4-(4-2)

See Ring 1 at 12:15 PM for balance of assignment.

### CONCURRENT SHOW

**Waukesha Kennel Club, Inc. 4-6 Months Puppy**

### RING THIRTEEN

**JUDGE: Mr. Mark Russo**

#### 9:30 AM

- 1 Chihuahuas (Long Coat)
- 1 English Toy Spaniels (Blenheim & Prince Charles)
- 1 Pomeranians
- 4-6 Month Puppy Toy Group**
- 1 Airedale Terriers
- 1 American Hairless Terriers
- 2 Lakeland Terriers
- 1 Miniature Bull Terriers
- 1 Norfolk Terriers
- 2 Soft Coated Wheaten Terriers
- 4-6 Month Puppy Terrier Group**
- 3 Bernese Mountain Dogs
- 1 Danish-Swedish Farmdogs
- 1 Doberman Pinschers
- 2 Great Danes
- 1 Leonbergers
- 1 Samoyeds
- 4-6 Month Puppy Working Group**

#### 10:30 AM

- 1 Retrievers (Flat-Coated)
- 1 Retrievers (Golden)
- 1 Retrievers (Labrador)
- 1 Setters (English)
- 1 Setters (Gordon)
- 1 Spaniels (Field)
- 4-6 Month Puppy Sporting Group**
- 1 Dalmatians
- 4-6 Month Puppy Non-Sporting Group**
- 1 German Shepherd Dogs
- 3 Shetland Sheepdogs
- 4-6 Month Puppy Herding Group**
- 1 Dachshunds (Smooth)
- 1 Whippets
- 4-6 Month Puppy Hound Group**
- Best 4-6 Month Puppy in Show**
- 33 Total Dogs

### RING FOURTEEN

**JUDGE: Ms. Kathy L. Wilkins**

#### 8:00 AM

- 17 \*Berger Picards 1-10-(1-4)-1
- 2 Old English Sheepdogs 1-0-(1-0)

#### 9:00 AM

- 31 \*Cardigan Welsh Corgis 10-14-(3-4)

#### 10:30 AM

- 9 Australian Cattle Dogs 5-1-(2-1)

59 Total Dogs

### RING FOURTEEN

**JUDGE: Mr. Harold "Red" Tatro, III**

Continuation of assignment from Ring 6 at 10:00 AM

#### 11:30 AM

Specialty

- 10 Soft Coated Wheaten Terriers 1-3-(1-5)

See Ring 8 at 12:45 PM for balance of assignment.

### RING FOURTEEN

**JUDGE: Mrs. Kylie Jo Hirschy-Seivert**

#### 12:00 NOON

- 5 Top Junior Handler

5 Total Dogs

### RING FIFTEEN

**JUDGE: Mrs. Honey Anne Glendinning**

#### 8:00 AM

- 34 Bernese Mountain Dogs 8-11-(12-2)-1

#### 9:20 AM

- 10 Spaniels (Clumber) 2-2-(3-3)
- 14 Setters (Gordon) 3-7-(1-3)

#### 10:20 AM

Specialty

- 33 Setters (English) 8-11-(6-8)

See Ring 7 at 11:45 AM for balance of assignment.

## SUNDAY

**Obedience/Rally Contact:**  
**Donna Schmidt (920) 285-4842**

**RING SIXTEEN**  
**JUDGE: Mr. James Comunale**

**(Judge will take a 45 minute luncheon break at his discretion)**

**8:00 AM**

- 12 Utility Class B & Preferred Utility Obedience Entries  
Nos P58 31 34 35 36 37 39 41 42 44 45 47

**9:45 AM**

- 1 Utility Class A Obedience Entries  
Nos 51

**9:55 AM**

- 1 Graduate Open Class Obedience Entries  
Nos 76

**10:05 AM**

- 5 Open Class A Obedience Entries  
Nos 25 26 27 14 29

**10:45 AM**

- 15 Open Class B & Preferred Open Obedience Entries  
Nos P56 P57 31 32 34 35 36 37 38 39 41 42 44 45 47

**After Noon**

- 1 Graduate Novice Class Obedience Entries  
Nos 73

**After Noon**

- 7 Novice Class B Obedience Entries  
Nos 8 9 16 17 19 20 21

**After Noon**

**A 5 minute walk-thru prior to the start of the Preferred Novice Class will be allowed for handlers without their dogs**

- Class to follow  
2 Preferred Novice Class Obedience Entries  
Nos P53 P54

**After Noon**

**A combined 5 minute walk-thru prior to the start of the Beginner Novice Classes will be allowed for handlers without their dogs**

- Class to follow  
3 Beginner Novice Class A Obedience Entries  
Nos 60 61 63  
5 Beginner Novice Class B Obedience Entries  
Nos 64 66 70 71 72

**RING SEVENTEEN**

**JUDGE: Mrs. Anna Lorenz**

**(Judge will take a 45 minute luncheon break at her discretion)**

**8:00 AM**

**Rally Choice Class Walk Thru**  
Class to Follow

- 4 Rally Choice Class  
Nos 62 116 125 128

**8:25 AM**

**Rally Master Class Walk Thru**  
Class to Follow

- 19 Rally Master Class  
Nos 60 62 63 64 65 116 117 72 120 77 89 90 91 95 122 123 124 125 126

**9:30 AM**

**Rally Excellent Class A Walk Thru**  
Class to Follow

- 2 Rally Excellent Class A  
Nos 107 59

**9:50 AM**

**Rally Excellent Class B Walk Thru**  
Class to Follow

- 20 Rally Excellent Class B  
Nos 60 62 63 64 65 109 66 71 72 111 112 77 82 89 90 91 95 98 113 114

**11:00 AM**

**Rally Advanced Class A Walk Thru**  
Class to Follow

- 3 Rally Advanced Class A  
Nos 57 58 59

**11:20 AM**

**Rally Advanced Class B Walk Thru**  
Class to Follow

- 21 Rally Advanced Class B  
Nos 60 62 63 64 65 66 69 71 72 74 76 77 82 89 90 91 94 95 97 98 102

**After Noon**

**Rally Intermediate Class Walk Thru**  
Class to Follow

- 9 Rally Intermediate Class  
Nos 45 46 47 48 50 51 52 54 55

**After Noon**

**Rally Novice Class A & B Walk Thru**  
Class to Follow

- 10 Rally Novice Class A  
Nos 5 6 7 8 9 10 14 16 18 21  
9 Rally Novice Class B  
Nos 22 24 30 34 37 38 40 41 42

## RING TWELVE

**2:30 PM Variety Groups and Best in Show**

(The groups will be judged in the following order unless otherwise announced)

Toy .....	Mr. Raymond V. Filburn, Jr.
Non-Sporting .....	Mr. David L. Kittredge
Terrier .....	Mr. Harold "Red" Tatrow, III
Hound .....	Mrs. Kalen M. Dumke Voogt
Working .....	* Ms. Joyce Siddall
Herding .....	Mr. Richard Lashbrook
Sporting .....	* Ms. Nancy E. Talbott
Best in Show .....	Mrs. Honey Anne Glendinning

## SUNDAY

### RING FOURTEEN

#### 2:00 PM Owner-Handled Variety Groups and Best Owner-Handled in Show

Owner-Handled Toy .....	Ms. Linda George
Owner-Handled Non-Sporting .....	Mrs. Cynthia L. Pagurski
Owner-Handled Terrier .....	Mrs. Christine E. Calcinari
Owner-Handled Hound .....	Mrs. Christine E. Calcinari
Owner-Handled Working .....	Mrs. Jo Ann Pavey
Owner-Handled Herding .....	Ms. Kathy L. Wilkins
Owner-Handled Sporting .....	Mrs. Jo Ann Pavey
Best Owner-Handled in Show .....	Mrs. Linda Clark

#### JUDGES - APPLIES TO EACH DAY

Dr. Bree Ardizzone-Sulewski .....	De Pere, WI 54115
Mr. Joseph Beccia .....	Valley City, OH 44280
Ms. Rita J. Biddle, Esq. ....	Eagle, MI 48822
Mrs. Janet Bodin .....	Waukesha, WI 53188
Mrs. Christine E. Calcinari .....	Portsmouth, NH 03801
Mrs. Linda Clark .....	Jenks, OK 74037
Mrs. Bergit Coady-Kabel .....	Indio, CA 92201
Ms. Karen Coffey .....	Chester Springs, PA 19425
Mr. James Comunale .....	Ballwin, MO 63011
Ms. Karrie Dollar .....	Bonduel, WI 54107
Ms. Karen A. Dumke .....	Florence, WI 54121
Mrs. Kalen M. Dumke Voogt .....	Show Low, AZ 85901
Mr. Raymond V. Filburn, Jr. ....	Newmarket, NH 03857
Ms. Linda George .....	Waukesha, WI 53186
Mrs. Honey Anne Glendinning .....	Lethbridge, AB, CN T1K 7W1
Ms. Patricia K. Gregg .....	Oakdale, CA 95361
Mrs. Angie Hartley .....	Ortonville, MI 48462
Mrs. Kylie Jo Hirschy-Seivert .....	Waukesha, WI 53188
Mr. David L. Kittredge .....	Rochester, NY 14619
Mr. Richard Lashbrook .....	Springfield, IL 62704
Mrs. Anna Lorenz .....	Elkhart Lake, WI 53020
Mr. Richard (Rick) Orlowski .....	Livonia, MI 48154
Mrs. Betsey Orman .....	Summit, WI 53066
Ms. Cynthia L. Pagurski .....	Lombard, IL 60148
Mrs. Abigail (Abby) S. Patrizio .....	Clinton, CT 06413
Mrs. Jo Ann Pavey .....	Barrie, On, CN L4N 5V7
Ms. Leeann Podruch, DDS .....	Hatley, WI 54440
Ms. Patricia Proctor .....	Yarmouth Port, MA 02675
Mr. Mark Russo .....	New Hartford, CT 06057
Mr. Leonardo Saldana .....	Nuevo Leon, MEX
Ms. Joyce Siddall .....	Englewood, CO 80113
Dr. Jerry Sulewski .....	De Pere, WI 54115
Ms. Wanda Tait .....	Summerland, BC, CN V0H 1Z1
Ms. Nancy E. Talbott .....	Quartz Hill, CA 93536
Mr. Harold "Red" Tatro, III .....	Crowley, TX 76036
Ms. Kathy L. Wilkins .....	Monticello, GA 31064
Ms. Joyce B. Winkels .....	Burlington, WI 53105

#### \*PROVISIONAL/PERMIT JUDGE - SEE ASSIGNMENTS

**IMPORTANT** - TRANSFERS of dogs from regular classes to Best of Breed/Variety Competition (Ch. 11 Section 6, AKC Rules) MUST be made to the Superintendent/Show Secretary at least one half hour prior to the start of any regular conformation judging at this show. TRANSFERS by Junior Handlers from Novice to Open Class or from the Open to Master Class MUST be made to the Superintendent/Show Secretary prior to the judging of the class at the show. SUBSTITUTIONS of Junior Showmanship dogs must be made prior to the judging of the class at the show. TRANSFERS OF DOGS IN OBEDIENCE/RALLY CLASSES (Ch. 1 Section 16 of Obedience Regulations) The request for transfers must be in writing and presented to the Superintendent/Trial Secretary at least 30 minutes prior to the start of each trial. Transfers for Obedience may be approved, provided the next level class and judge are available and the class has not reached its limit.

## **AKC Sanctioned 4 & Under 6 Months Puppy Competition**

This is a recorded event by the AKC for the Certificate of Merit and Puppy of Achievement certificates.

### **Section 1 - Classifications**

The Four-to-Six Month Puppy competition shall be for dogs that are four months of age and over, but under six months on the first day of the event. Classes will be offered for breed and varieties and divided into Groups as described in Chapter 3, Section 1 of the Rules Applying to Dog Shows.

### **Section 2 - Entry and Eligibility**

For additional information on entry and eligibility requirement, please see the Sanctioned Four-to-Six Month (Beginner Puppy) Competition Regulations available on the AKC website at

[https://images.akc.org/pdf/rulebooks/Sanctioned\\_Regulations\\_4-6\\_Month\\_POA.pdf](https://images.akc.org/pdf/rulebooks/Sanctioned_Regulations_4-6_Month_POA.pdf)

**NO PUPPIES UNDER THE AGE OF SIX (6) MONTHS, EXCEPT THOSE PARTICIPATING IN THE 4-6 MONTH PUPPY COMPETITIONS, MAY BE ON THE GROUNDS.**

---

**The following breeds must be judged on a Ramp** through all levels of conformation competition: Lagotti Romagnoli, Clumber Spaniels, Sussex Spaniels, Basset Hounds, Cirnechi dell'Etna, Kerry Blue Terriers, Bulldogs, Chinese Shar-Pei, Chow Chows, Keeshonden, Spanish Water Dogs. Breeds designated as ramp optional may, at the discretion of the judge, be judged on a ramp through all levels of competition. The full policy and list of Table and Ramp eligible/required breeds is available on the AKC website at:

[https://images.akc.org/pdf/judges/table\\_breeds.pdf](https://images.akc.org/pdf/judges/table_breeds.pdf)

Judges may request the ramp to judge any breed in emergency situations; if granted, unless the use of a ramp has been indicated in the premium list, an exhibitor has the option of withdrawing their entry and receiving a refund.

Junior Showmanship judges should follow the above.

### **NOTICE**

Junior Handlers who win a third Novice Class with competition present or a first place in Novice without competition leading to a Best Junior award with competition would count as one win towards moving to Open, after the closing of entries for a show, **ARE REQUIRED TO TRANSFER** their entry from the Novice Class to the Open Class. **MUST NOTIFY** the Superintendent/Show Secretary prior to the judging of the class at the show.

**JUNIORS WITH A DOG ALSO ENTERED IN ANOTHER CLASS OFFERED AT THIS SHOW WHO SUBSTITUTE A DOG NOT ENTERED IN THIS SHOW MUST REMIT THE DIFFERENCE BETWEEN JUNIOR SHOWMANSHIP ONLY AND JUNIOR SHOWMANSHIP AS AN ADDITIONAL CLASS ENTRY FEE. JUNIORS WHO HAVE ENTERED JUNIOR SHOWMANSHIP ONLY WHO THEN SUBSTITUTE ANOTHER DOG WILL NOT BE CHARGED A FURTHER FEE.**

---

**THE CLUB(S), THEIR SUPERINTENDENT AND/OR EVENT SECRETARY** caution all persons entering the show site and show grounds against all hazards which may exist, including, but not limited to: Condition of the site/grounds, parking/loading/unloading areas, entrances, floors and stairways, elevators and escalators, floor coverings, walkways, tenting/canopies, electrical appliances, cords and fittings, exercise pens, and the presence of animals. All persons should take into consideration this is a sporting event and dress, act and exercise caution appropriate for the activity involved. All persons should exercise caution and common sense in any interaction with any animal present. All persons entering the show, the grounds, site, ring and any show areas for whatever purpose do so entirely at their own risk. By virtue of entering the show, the entrant has indicated their acceptance of the terms listed in the premium list and on the entry form and assumes all risks involved.

---

**AKCTV will be broadcasting  
Waukesha's Saturday Group and  
Best in Show judging.**



**PUBLICATION RIGHTS:** By entering this show, all owners, handlers, breeders, and kennels agree that all rights to televise, videotape, photograph, advertise, promote, and publicize or otherwise exploit this show, or the persons or animals participating in it or the results of the competition before, during or after the event, shall belong solely to the American Kennel Club and their respective assigns, including the use of names, likenesses, or biographical matter of all dogs, owners, handlers, breeders, and kennels participating in the show and no such owner, handler, breeder, or kennel shall allow any other party to make commercial use of any videotape or photograph of any person or animal participating in this competition. **NOTE:** By entering these shows all owners, handlers, breeders, and kennels agree to make themselves available for interviews if requested.

### Official Photographer

Booth Photography, P.O. Box 308, Williamston, MI 48895  
(517) 655-4081 Website: [www.boothshowphoto.com](http://www.boothshowphoto.com)  
(Only the Official Photographer may take win pictures.)

### **Three amazing photographers available for ringside or private photo sessions!!**

The following photographers have the right to shoot images during the conformation event  
(excluding Dock Diving, Obedience, Rally, Fetch & FastCat).

Any Freelance Photographers who are not listed below and found working the event will be asked to cease their activity.

#### **Alyssa Janiszak Photography & Design**

E-mail: [valorkennel@aol.com](mailto:valorkennel@aol.com) Website: <https://alysasjaniszak.shootproof.com/>

#### **Eddie Baute MyAngel Studios LLC**

E-mail: [myangelstudios@gmail.com](mailto:myangelstudios@gmail.com) (917) 288-2994 Website: [myangelstudios.com](http://myangelstudios.com)

#### **Hounds in Motion by Tori Lee**

Victoria Lee Website: [houndsinmotion.com](http://houndsinmotion.com)

***"Exhibitors should follow their veterinarian's recommendation to assure their dogs are free of internal and external parasites, any communicable diseases, and have appropriate vaccinations."***

#### **Veterinarian On Call**

Wisconsin Veterinary Referral Center  
360 Bluemound Rd., Waukesha, WI 53188 (262) 542-3241

**DIRECTIONS TO EMERGENCY VETERINARY SERVICE:** Left turn out of show grounds, left on Pewaukee Rd. ("J"), turn right onto Bluemound Rd. ("JJ"), veterinary facility almost immediately on left.

**An Automated External Defibrillator (AED) and EMT are on site.**

---

Please Join Us for a

### **BEST OF THE BEST IN SPECIALTY SPECTACULAR!**

All Specialty Best of Breed Winners - from every Specialty (Independent, Concurrent or Designated) for every breed held Thursday, Friday, Saturday & Sunday, July 24, 25, 26, 27th are eligible to compete! ***Best of the Best in Specialty Winner will receive a Gorgeous Rosette & \$500.00 Cash. Reserve Best of the Best in Specialty will receive a Gorgeous Rosette & \$300.00 Cash. All Prizes are offered by the Waukesha Kennel Club, Inc., the Combined Specialty Clubs of Greater Milwaukee, Inc. & Betsey Orman.*** Competition will be held on Sunday after the completion of all breed judging.

Judge: Mrs. JoAnn Pavey

---

## **PEE WEE CLASS OFFERED**

### **SATURDAY, JULY 26, 2025, 12:00 NOON**

Judges: Valerie Black & Marylou Mader-Pipia

***5-year-old to under 9-year-old children can join the fun of dog showing!***

***This new class is offered to inspire young handlers to love and show their dogs.***

- Pre-entry encouraged. Entry Limited to 24 children - 12 per two rings.
- Day-of-show entries will be accepted if entries are not filled.
- Dogs are to be AKC eligible and at least 4 months old.
- Children enter the ring with their dog one at a time and are to be accompanied by a responsible adult. Only one team is in the ring at a time.
- Detailed information may be found at:

<https://www.waukeshakennelclub.org/summersplashdogshow>

E-mail Shelby Naab at [naabx009@gmail.com](mailto:naabx009@gmail.com)

Entry Fee: **FREE**

Mail Pre-entries to: Shelby Naab at [naabx009@gmail.com](mailto:naabx009@gmail.com) by July 18, 2025. Prior to the beginning of the class, the responsible adult will sign a RELEASE OF LIABILITY FORM (Forms available on the WKC website and at the show). Judging will begin approximately at 12:00 Noon, Saturday, July 26, 2025. Check-in or enter at the WKC information booth by 11:00 A.M.

<p><b><i>Pee Wees are sponsored by Mary Alice Eschweiler &amp; Janet Bodin, with special contributions by Cynthia M. Steiner, in memory of David Addington.</i></b></p>
---

Each child will receive a Multi-Colored Rosette Sash and a Coloring Book, *Best in Show: An Alphabet Adventure* offered by Cyndy Steiner/Cynsational by Cyndy Rosettes in memory of David Addington.

**SEE PAGE 16 OF THE PREMIUM LIST FOR ADDITIONAL INFORMATION.**

## EXPO RULES AND RV GUIDELINES

THESE RULES WILL BE STRICTLY ENFORCED. Anyone who either ignores the directions of the Parks staff at the gate or bypasses them in some manner will be subject to an Event Committee Hearing, per the Waukesha Kennel Club, Inc.

- The only vehicles allowed within the show area (within 50' of all rings), are First Aid, Security, Expo Staff, and Waukesha Kennel Club, Inc. dog show staff. All private golf carts, utility vehicles, and ATVs must be used around the outer perimeter of the event.
- Day RV Camping ONLY in Gate #1. No overnight parking will be allowed. Anyone who chooses not to abide by this rule will be asked to move their RV to the overnight RV camping area through Gate #3 and will be required to pay the appropriate overnight fees. Noncompliance will result in your RV being towed at your expense.
- Entrance to RV Camping is Gate #3. Upon arrival to Gate #3, participants will need to provide a copy of their registration confirmation. Once registration has been verified, an admission pass will be provided to be displayed in the window of the RV. Access to Gate #3 is limited to:
  - o Recreational vehicles with proper admission pass displayed. One extra vehicle per RV site. Mirror hanger provided for the extra vehicle.
  - o Handler/Exhibitor vehicles with proper Admission pass. Any handler/exhibitors without proper pass must purchase admission and display admission pass. **NO DROP OFF will be allowed without proper pass display.**
  - o Club members, Judges, Volunteers and workers with appropriate pass (Friday – Sunday).
- After 10:00 P.M., RVs are welcome to enter Gate #3 to be staged in Arena West Parking Lot until the next morning. No electrical hookups available. Wednesday arrivals are welcome from 3:00 P.M. until 10:00 P.M. and Thursday - Saturday 6:00 A.M. until 10:00 P.M.
- A noise curfew is in effect from 10:00 P.M. until sunrise. This applies to all types of loud noises, including, but not limited to, music and stereos. Please be considerate of your neighbors so everyone can have a pleasant time.
- Grills are allowed by individual RV sites only, not on the show grounds. Hot coals should not be dumped into Expo trash containers or dumpsters. Absolutely NO campfires of any kind are allowed.
- No tent camping will be allowed.
- All dogs must be kept on a 6 feet or less leash, unless in designated dog show rings.
- All campers are responsible for cleaning up and properly disposing of all trash, recyclable items and dog droppings. Place items in proper receptacles found throughout the Expo Grounds. Failure to follow this rule may result in additional charges or not being allowed to camp on-site for future shows.
- Cancellations of RV Camping and Handler Parking: A full refund will be given if canceled on or before July 16, 2025. If canceled July 16, 2025 or later, the reservation fee will be forfeit.

**\*\*\*IN CASE OF EMERGENCY, DIAL 911 AND DIRECT THE EMERGENCY PERSONNEL TO ENTER THE GROUNDS FROM GATE #3\*\*\***

---

## SITE INFORMATION

- OBEDIENCE & RALLY TRIALS WILL BE HELD INDOORS IN THE AIR-CONDITIONED ARENA.
- THERE WILL BE NO CONFORMATION EVENTS IN THE ARENA BUILDING. AMPLE CRATE SPACE IS AVAILABLE ON THE UPPER MEZZANINE AND THROUGHOUT THE SHOW ARENA, NO GROOMING ALLOWED. NO CRATES PERMITTED ON THE STAGE.
- RESERVED GROOMING IS AVAILABLE IN THE AIR-CONDITIONED FORUM BUILDING – SEE PAGE 13.
- WAUKESHA KENNEL CLUB ENCOURAGES ALL TO KEEP GROOMING AREAS CLEAN.
- **THREE** OUTSIDE GROOMING TENTS AVAILABLE WITH ACCESS TO POWER, BRING CORDS.
- OUTSIDE BATHING STATIONS ON THE WEST SIDE OF THE FORUM BUILDING. AVAILABLE THURSDAY THROUGH SUNDAY.
- **OUTDOOR RUGS IN OUTDOOR GROOMING AREAS ARE LIMITED TO 5' X 7' IN SIZE.**

---

### NO PRACTICING ALLOWED IN RINGS AT ANY TIME.

**Dogs May Arrive** any time prior to their scheduled time of judging. **Dogs not required for further judging will be excused.**

**Judges Will Not Wait for Any Dog Holding Up a Class.** Owners or agents alone are responsible for the presence of their dogs in the judging ring when their classes are called to be judged.

**All Dogs Present** must be held on leash or confined to their crates except when being judged or when in the exercising ring.

**No gasoline or diesel generators** are permitted inside any building or within 100 feet of any tent in which this dog show is conducted.

**As specified in Chapter 12, Section 4** of the AKC Rules Applying to Dog Shows, information contained on the entry form is required to be published in the club's show catalog. This information is also subject to publication in other media.

**Entry Fees** shall not be refunded in the event that a dog is absent, disqualified, excused by Veterinarian or Judge, or barred from competition by action of the event's Show Committee. If because of riots, wars, strikes, civil disturbances, national emergencies, health emergencies, and the dictates of law enforcement or of the owner(s) of the grounds and/or facilities or other acts beyond the control of the management it is impossible to open or to complete the show, no refund of entry fee will be made. Extreme weather conditions, such as, but not limited to, snow storms, hurricanes, lightning, extreme heat, heavy rains, or other circumstances including, but not limited to, the condition of the facilities or grounds and/or the ingress and egress from the grounds, must be considered for the health and safety of the dogs, exhibitors and spectators. The well-being of dogs, exhibitors and spectators is of paramount importance and, in the event it is necessary to cancel or stop the show before completion, no refund of entry fee will be made.

## EXHIBITOR INFORMATION

- **BUILDINGS WILL BE OPEN AT NOON ON THURSDAY, JULY 24, 2025.**
- \$10.00 per carload at the gate. A 3-day pass at the gate will be \$25.00 and a 2-day will be available. **Credit card & cash accepted at the gate on show days! No \$50 or \$100 bills accepted.**
- **SAVE MONEY & TIME** - Pre paid multi-day admission (3 & 2-day) **book online & save! Purchase by July 24, 2025 at [waukeshakennelclub.org/summersplashdogshow](http://waukeshakennelclub.org/summersplashdogshow)** Buy a 3-day pass for \$21.00, \$15.00 for 2-day pass. Your ticket will be sent to your phone. You will receive a mirror hanger upon presentation & speed through the lines all subsequent days!
- **CATALOGS WILL BE AVAILABLE AT THE GATE & INFORMATION TABLE UNTIL SOLD OUT.**
- No unentered Dogs allowed.
- Indoor Restrooms. **NO DOGS PERMITTED IN THE SHOWERS OR LAVATORIES.**
- Restrooms & Show Location are handicapped accessible.
- **NO GROOMING** will be allowed in the Arena Building.
- Dogs may be crated in Arena Mezzanine.
- **NO PRIVATE EXERCISE PENS ALLOWED IN ANY BUILDING.**
- **NO PRIVATE TENTS OR POP-UPS WILL BE ALLOWED** next to rings (except Dane & Malamute ring). All tents must be staked **at least 10 feet from ring stanchions.**
- No Pop-Ups may be set up until **ALL RINGS** are set by the Superintendent.
- **ALL EZ UP TENTS MUST BE STAKED DOWN.**
- Food will be available on Friday in the North Hall with additional outdoor vendors on the weekend.
- NO picnics allowed on the show grounds without Show Chair approval. Picnics are allowed at RV sites only.
- **WKC is SHOW & GO! CRATES/TROLLEYS ALLOWED RINGSIDE/UNDER TENTS** in Designated Area only. Set up no more than one hour before ring time & **MUST BE REMOVED 30 MINUTES AFTER COMPLETION OF JUDGING.** Non-compliant crates/trolleys are subject to removal by Show Committee.
- **DOG CRATES IN GROOMING BUILDING MUST HAVE A CONTACT NUMBER ON THEM IN CASE OF EMERGENCY.**
- No dogs that are disqualified for aggression will be allowed to enter these Shows, nor be allowed to be on the grounds. In addition, no aggression reinstatement procedures will be performed at these Shows.
- Dogs found in an unsafe environment, distress or harm's way (for example: left unattended on a grooming table in a noose not attached to a safety release clip; left in a vehicle without proper ventilation) will be removed to safety. Exposing a dog to an unsafe environment, distress or harm's way is considered mistreatment.
- Exhibitors are responsible for cleaning up after their dogs with their own equipment in the entire facility, including Ex-pens. There will be public scoop stations on the show grounds.
- When a club member/volunteer asks you to do something, please realize that they are doing this to follow regulations and do NOT take any irritations out on them. We will not hesitate to ask you to leave if we feel you are being abusive.
- Non Grooming Tables allowed only adjacent to assigned breed ring. No tables may be set in aisles, or adjacent to the ring if it affects any passageway between rings or set of rings.
- No blaster-type hair dryers allowed after judging commences in indoor grooming areas with a show ring (EAST HALL) - handheld, low force dryers are okay.

***It's Summer! Wear cool but professional attire.***

**NOTE: In order to comply with the provisions of Wisconsin Statutes [s. 95.21 (2)] and Administrative Codes [s. ATCP 11.52], relating to the Statewide Rabies Control Program, the owner of any dog kept or exhibited in Wisconsin (other than a dog kept for educational or scientific purposes) shall have the dog vaccinated against rabies by a veterinarian at no later than 5 months of age and revaccinated within one year after the initial vaccination.**

Any person (including out-of-state exhibitors) who imports a dog into Wisconsin (for exhibition or any other purpose) must have a valid interstate health certificate or certificate of veterinary inspection for that dog, regardless of the age of the dog. The certificate must be completed by a veterinarian; accompany the dog when it enters this state; and indicate the current vaccination status of the dog. Vaccinations shall be administered by a veterinarian and comply with age and time standards and label instructions approved by the federal bureau for the type of vaccine used.

Additional information regarding these regulations may be obtained from the Wisconsin State Veterinarian at (608) 224-4888.

### EXHIBITORS PLEASE NOTE:

All Royal Canin prizes, if not presented in the ring, must be picked up during the event at the Royal Canin booth. Presentation of the winning ribbon is required. Royal Canin reserves the right to make prize substitutions of equal or greater value in the event a specific listed prize is not available

It is also understood that each club associated with the Waukesha Summer Splash Shows reserves the right to substitute any unavailable prize(s) with one(s) of equal or greater value. Prizes must be claimed the day of the show(s). None will be mailed. Unclaimed prizes will become property of the club which offered said prize.

## ALL BREED SANCTIONED B MATCH FRIDAY, JULY 25, 2025

*Have Fun with your Puppies & Adults! Gain ring experience!*

*Join us for our PIZZA PARTY! Free to all exhibitors!*

**Best Puppy in Match - \$50.00    Best Adult in Match - \$50.00**

**Best Junior Handler in Match - \$25.00 • Each also awarded Stone Pony Pottery Prizes!!**

Awards sponsored by Betsey Orman & Sue Zimmer "Stone Pony"

The Match will be held at Waukesha County Expo Center - Outdoor Rings • **Start time 5:30 P.M.**

Puppy Classes offered: 3-6 Mos., 6-9 Mos., 9-12 Mos. • Adult Classes offered: 12-18 Mos.

Open Juniors & Miscellaneous Breeds are offered

Pre-Entries **\$10.00**    Day of Match Entries **\$15.00**    Juniors only **\$5.00**

***New! We can take credit cards for DAY OF ENTRIES!***

**MATCH JUDGES:**

Bill Fussaro • Katie Guse • Brandy Ketchum • Teri Peterson

**BEST PUPPY IN MATCH:** Bill Fussaro • **BEST ADULT IN MATCH:** Brandy Ketchum • **BEST JUNIOR HANDLER:** Katie Guse

Entry Form and more information at [www.waukeshakennelclub.org/summersplashdogshow](http://www.waukeshakennelclub.org/summersplashdogshow) – Match Tab

**For more information contact our Match Secretary, Kait Ryan, 532 E. Townsend St. Apt. 3, Milwaukee, WI 53212  
or Match Chair, Valerie Black • E-mail: valblack4@gmail.com**

---

## OFA EYE EXAMS

Gillian J. McLellan, BVMS, PhD, DipECVO, DVOphthal, MRCVS, FARVO

Saturday, July 26, 2025 - 9:00 A.M. - 4:00 P.M.

**\$65.00 per exam. All monies donated to UW Foundation in support**

**of veterinary ophthalmology research and training programs.**

**We strongly encourage on-line registration at OFA.org.** It is important that you bring a copy of the OFA registration to the eye clinic. We will have limited access to recording forms.

For payment and scheduling information contact Jewel at [jewelcalton@rocketmail.com](mailto:jewelcalton@rocketmail.com)

Appointments can be made prior to the day of the clinic and pre-registration closes on July 21, 2025. It is understood that the schedule is tentative and considerations for ring times will need to be made whenever possible. Pre-registrations will require payment before the clinic. Walk-ins welcome if time-slots are available.

Due to the varying amount of time to complete these examinations, all scheduled times are approximate. We ask for your understanding of our attempt to provide these services to as many dogs as possible.

All entries will be sent an E-mail confirmation or phone call.

**SEE PAGE 20 OF THE PREMIUM LIST FOR ADDITIONAL INFORMATION.**

---

## OFA CARDIAC SCREENING: ECHOCARDIOGRAMS

Dr. Heidi Kelliham, DVM, DACVIM (Cardiology)

Saturday, July 26, 2025 • 9:00 A.M. - 4:00 P.M.

*Appointments can be made prior to the day of the clinic. Pre-registration closes July 21, 2025.*

*E-mail confirmations will be sent to all pre-registrants who are paid in full with registration.*

*Ring times will be accommodated as best we can.*

LOCATION – FOX RIVER ROOM in the ARENA BUILDING. Walk-ins are welcome the day of the clinic time permitting.

**For more information, E-mail: [jewelcalton@rocketmail.com](mailto:jewelcalton@rocketmail.com)**

Remember, you must bring your dog's registration number with you so that you can complete the form that you will mail into the OFA.

Heart Exams: Auscultation - **\$60.00**    Echocardiogram - **\$280.00**

Due to the varying amount of time needed to complete these examinations, all scheduled times are approximate. We ask for your understanding of our attempt to provide these services to as many dogs as possible.

All entries will be sent an E-mail confirmation or phone call.

**SEE PAGE 21 OF THE PREMIUM LIST FOR ADDITIONAL INFORMATION.**

---

## MEET THE BREEDS

***Hear ye, hear ye, BREED all about it...***

**Breeders presenting their dogs throughout the day.**

**Experienced: Knowing what the breed was bred for.**

**Dedicated: Breeding to the standard.**

**Champion Lines: Honoring the dogs of the past.**

**Looking for a well bred dog, come no farther!**

**Meet The Breeds will run from 9:00 A.M. until 3:00 P.M. both Saturday and Sunday.**

**We will feature up to two breeds at a time.**

**Contact: Marylou Mader-Pipia at [mader775@gmail.com](mailto:mader775@gmail.com) to prearrange a Breed time or sign ups onsite are fine, too.**

**Meet The Breeds will be held in a designated area in the Information/Superintendent tent.**

**Friday & Saturday Obedience & Rally Trials will be photographed by  
Isabelle McKee, Spot On Images**

Website: <https://spotonimages.zenfoliosite.com/>

Sign up at: <https://form.jotform.com/spotonimageswi/wkc-july25>

**ATTENTION EXHIBITORS OF FOREIGN DOGS**

Please visit: <https://www.cdc.gov/importation/dogs/index.html>  
for the most recent updates regarding bringing a dog into the U.S.

**The American Kennel Club presents  
"Judging Junior Showmanship"**

*Held in conjunction with the Waukesha Kennel Club show*

July 26, 2026 • Waukesha, Wisconsin • \$50.00

Please review the Junior Showmanship Rulebook prior to attending the seminar: <http://images.akc.org/pdf/rulebooks/REJRSH.pdf>

\*Please meet at the Superintendent's office 30 minutes prior to the start of Junior Showmanship Judging

To Register complete and return to: American Kennel Club • Judging Operations Department • PO Box 900062

• Raleigh, NC 27675-9062 • 919-816-3589 • fax# 919-816-4225

**Cash cannot be accepted**

*The AKC retains all rights to photograph or videotape by any means, televise or reproduce these events in any way, now and in the future.*

*Photos of this event may be used, but are not limited to, future educational literature, training purposes, newsletters, or advertisements.*

**NO REFUNDS ONE MONTH PRIOR TO THE DATE OF THE SEMINAR**

Seminar to be conducted in-conjunction with Junior Showmanship Judging

SEE PAGE 6 OF THE PREMIUM LIST FOR ADDITIONAL INFORMATION.

**NEW IN 2025  
PURCHASE MULTI-DAY ADMISSION ONLINE!**

**Speed through the gate and Save \$\$**

<https://www.waukeshakennelclub.org/summersplashdogshow>

**Regular admission per carload** is \$10.00/one-day; \$20.00/two-day and \$25.00/three-day.

We accept cash & credit cards at the gate (NO \$50 or \$100 BILLS).

**Save time & money! Pre-purchase your Multi-Day Admission** online at the site above. You will be sent a QR code to your E-mail. Show the code at the gate on your first day & receive an admission hanger for your rearview mirror - waive through on all subsequent days.

**Multi-Day Admission Pass Prices:** Three-days - \$21.00 and Two-days - \$15.00

*All online purchases subject to taxes & fees.*

**ATTENTION JUDGES**

**You are invited for a unique chance to learn about Spanish Water Dogs!**

*WKC is delighted to host The Spanish Water Dog Club of America National Specialty. The Club is offering a terrific opportunity to learn about this wonderful breed!*

**What:** Spanish Water Dog Seminar & Hands On - up to three CEU

**When:** Sunday, July 27th at 8:00 A.M. CDST, followed by Hands On. Mentoring will be available at the ring late morning - see this Judging Program for ring and ring time.

**Where:** Round Arena Building - Bark River Room

**Cost:** \$20.00

**Events:** National Specialty Friday July 25th followed by two Designated Specialties on the weekend!

**Register:** <https://form.jotform.com/250494455852161>

**ARMBAND DRAWING**

**WIN A COUPON FOR YOUR CHOICE  
OF A FREE BAG OF ROYAL CANIN FOOD**



Simply stop by the Royal Canin Booth and drop your armbands to enter the drawing. 15 winning armbands will be drawn at 1:00 P.M. on Sunday at the Royal Canin Booth. Winners will be posted at that time. Pick up coupon at the show - none will be mailed.



## REGIONAL QUALIFIER JULY 24, 25, 26 & 27, 2025

North America Diving Dogs will be holding an all-breed dock diving event at the Waukesha County Kennel Club Summer Splash.

Titles are eligible for the AKC Title Recognition Program. Join the fun and excitement at this cluster and compete with your dogs for your titles or take the opportunity to try out the sport assisted by our experienced trainers. **Information and Preregistration will be online at**

<https://northamericadivingdogs.com/Event/info/eventid/5197>

Thursday, July 24, 2025 Splash #s	Friday, July 25, 2025 Splash #s
2:00 P.M.: Splash #301 (Air Retrieve)	9:00 A.M.: Splash#1 (Distance Jump)
4:00 P.M.: Splash #301 (Hydro Dash)	9:00 A.M.: Splash#2 (Distance Jump)
	9:00 A.M.: Splash#3 (Distance Jump)
	9:00 A.M.: Splash#4 (Distance Jump)
	4:00 P.M.: Splash#302 (Hydro Dash)

Saturday, July 26, 2025 Splash #s	Sunday, July 27, 2025 Splash #s
9:00 A.M.: Splash#5 (Distance Jump)	9:00 A.M.: Splash#9 (Distance Jump)
9:00 A.M.: Splash#6 (Distance Jump)	9:00 A.M.: Splash#10 (Distance Jump)
9:00 A.M.: Splash#7 (Distance Jump)	9:00 A.M.: Splash#11 (Distance Jump)
9:00 A.M.: Splash#8 (Distance Jump)	9:00 A.M.: Splash#12 (Distance Jump)
4:00 P.M.: Splash#102 (Air Retrieve)	<b>ALL SPLASHES MUST BE FINISHED BY 3:00 P.M.</b>

- Online registration **OPENS 5/8/2025 1:00 P.M. and closes 7/17/2025 at midnight (CDT)**
- Price per splash for this event is **\$30.00 (USD)** per dog. Payment is due upon check-in, cash or check preferred. Refunds will not be issued if you fail to show up for your turn.
- "Day of Show" entries may be available until limits are reached: 45 dogs per Splash (Distance Jump), 14 dogs per Splash (Air Retrieve), unless otherwise specified.

Splashes (\$30.00) include up to 3 minutes on the dock for one optional practice jump and two judged jumps. The jump order is first-come/ first-serve . Turn in your card to the board (anytime up to one hour before splash end time) to hold your place in line.

**Try-its** will be allowed as space permits and during Splashes if no competitors are waiting to jump. Try-its cost \$10.00 for two Try-it tickets. These tickets may be used on any day of the competition. **AS TIME ALLOWS:** If a Try-it or competing dog wishes to have more time, they may purchase additional tickets as timing allows.

Photographer -  
Barking Dog Images - Delafield, WI



## **FAST COURSING ABILITY TEST!**

**JULY 25, 26 & 27, 2025**

**<https://www.waukeshakennelclub.org/summersplashdogshow>  
FOR THE FASTCAT PREMIUM LIST & ENTRY FORM**

**Pre-entry \$27.00 per dog per test.**

**Late & day of entries (until limit is met) \$32.00 per dog per test.**

Open to all dogs at least one year of age by the day of the test that are individually registered with the American Kennel Club, recorded in the FSS program, dogs with PAL numbers, or dogs enrolled in the AKC Canine Partners program. Two events will run concurrently per day; a dog may enter only once per event. Each event has an individual event number for (6) entries available Fri-Sun. Gorgeous custom Rosettes offered for BCAT, DCAT & FCAT titles earned at our event!

Online entry encouraged for faster processing. Pre-entry and payment via online entry form or by mail to secretary address open May 30, 8:00 A.M. and close Wednesday, July 16, 2025, 6:00 P.M., unless the numerical limit is reached prior to the date after which time entries will not be accepted, canceled, altered or substituted. Phone, Fax, and E-mail entries will NOT be accepted. **Request for refund must be submitted within 30 days of event.**

<p><b>Online Entry &amp; Payment:</b> <b><a href="https://witallyho.wufoo.com/forms/wkc-july-fast-cat/">https://witallyho.wufoo.com/forms/wkc-july-fast-cat/</a></b></p>	<p><b>Field Secretary:</b> Erick Marchessault 71 Willow Cir., Cary, IL 60013 E-mail: <a href="mailto:erick@fastandfundogs.com">erick@fastandfundogs.com</a> Phone: (847) 217-2790</p>
<p><b>Physical Entry &amp; Payment:</b> Make check payable to: Waukesha Kennel Club, Inc. Mail completed entry form &amp; check to Field Secretary</p>	<p><b>Lure Operator:</b> Fast and Fun, LLC <b><a href="http://www.fastandfundogs.com">www.fastandfundogs.com</a></b></p>
<p><b>Event Photographer:</b> Greyhaus Photography and Design, LLC Alyse Henderson &amp; Samantha Charles E-mail: <a href="mailto:support@greyhausphoto.com">support@greyhausphoto.com</a> <b><a href="http://www.greyhausphoto.com">www.greyhausphoto.com</a></b></p>	

Canadian exhibitors must make fees payable in U.S. funds. Exhibitors whose checks are returned for NSF will be assessed a \$50.00 service fee. Entries will not be accepted if received without a signature, fees, or back of entry form with signed agreement. An official American Kennel Club Entry Form must be used. Telephone and telegraph entries cannot be accepted. No entry will be accepted which is made subject to conditions.

## RESERVED GROOMING

A limited number of indoor A/C Reserved grooming spots will be available on a first come, first reserved basis. Limit TWO spaces per exhibitor. WKC provides several large outdoor grooming tents with electric access. Bring your own extension cords.

No blaster-type hair dryers are permitted in the hall with a show ring once judging commences. Hand held/low force dryers are okay. A waiting list will be kept on the day of the show. Cancellations are not allowed. Reserved spaces have access to shared electric but is not exclusive and is not reserved for grooming. If you have no groomer, please let us know. If you have a groomer, you must send in the same envelope and we will attempt to accommodate as best possible. Spaces measuring approximately 5' x 9'. \$30.00 for the show weekend, no partial reservations accepted.

All space will be available on Thursday, July 25, 2025. Unless otherwise designated, if your reserved space is not occupied by 12:00 NOON on Thursday, July 26, it will be made available for Open.

For questions, E-mail: [bramblepup@outlook.com](mailto:bramblepup@outlook.com)

Cut off date July 16, 2025. No refunds will be made. We keep a waiting list & if you must cancel, Waukesha will connect you to the waiting list, if requested.

List of assigned space numbers will be posted on [www.waukeshakennelclub.org/summersplashdogshow](http://www.waukeshakennelclub.org/summersplashdogshow) one week prior to show. Assignments will also be posted on doors leading into South and East Hall.

**SEE PAGE 13 OF THE PREMIUM LIST FOR ADDITIONAL INFORMATION.**

## TOP WISCONSIN JUNIOR HANDLER

ATTENTION – STATE OF WISCONSIN JUNIOR HANDLERS: OPEN & MASTERS! ON SUNDAY, JULY 27, 2025, THERE WILL BE A "TOP WISCONSIN JUNIOR HANDLER OF THE YEAR" COMPETITION.

- Open to Wisconsin Residents - Ages over 9 years old and under 18 years.
- Open to Juniors with at least one First Place Win in Open Junior Showmanship Class or have been in the Master Junior Showmanship Class. The calendar for these classes will be from July 31, 2024 to July 9, 2025.
- There is no registration fee for this competition if the child is entered in regular Junior competition.
- Entry fee of \$10.00 if not entered in regular Junior Handling class.
- Dogs entered and handled in this class may also, but need not to be, entered in the Regular Show Class and are subject to all the provisions noted on entry form and in the premium list such as fees, closing date, and eligibility.

**Previous winners of the "TOP WISCONSIN JUNIOR HANDLER" main award - who is the recipient of the top scholarship Award - are not eligible for this competition.**

**- JUDGE -**

**Mrs. Kylie Jo Hirschy-Seivert**

The Winner of TOP WISCONSIN JUNIOR HANDLER award is not eligible to compete in this event again. All Runners Up ARE eligible to compete again.

\*The Top Junior award is a one-time scholarship for a post-secondary education, not necessarily a college or university. When the recipient enrolls, the Waukesha Kennel Club, Inc. will require enrollment conformation from the school. The scholarship payment will be sent directly to the school for credit to the Junior Handler's account. Any Junior, who does not redeem the scholarship by the age of 25 years old, will forfeit the scholarship. These Scholarship Awards are funded by: Waukesha Kennel Club, Inc. **All winners will be required to complete a form and turn in at the show in order to qualify for future payment.**

**Entries Closed Wednesday Noon (CDT), July 9, 2025**

**SEE PAGE 17 OF THE PREMIUM LIST FOR ADDITIONAL INFORMATION.**

**Hosted by the Spanish Water Dog Club of America**

## AKC Fetch Events

**Friday, Saturday, and Sunday, July 25-27**

Two Events Per Day -- All Levels Tested

Earn Three Titles in One Weekend!

**Judges: Ms. Mindy Mymudes • Ms. Karin Magnuson**

Event Photographer: Kimberly Hartman • [naturesessencephoto@gmail.com](mailto:naturesessencephoto@gmail.com)

**Dates/Times:**

Friday 7/25: 1:00 P.M. - 5:30P.M. (events 2025702007, 2025702008)

Saturday 7/26: 8:00 A.M. - 1:00 P.M. (events 2025702009, 2025702010)

Sunday 7/27: 8:00 A.M. - 1:00 P.M. (events 2025702011, 2025702012)

**Entry Fee: \$30.00 per test for pre-registration • \$35.00 per test day-of (if space remains)**

*Only 40 slots are available for each event, so register in advance to reserve your slot!*

**Details & Registration Link:** <https://TravelsWithPaco.com/fetch/>

- Unless otherwise specified, ribbons are offered by the Spanish Water Dog Club of America Inc. through the generosity of its members.
- SWD's earning a new Retriever title will be awarded a bumper through the generosity of Ohana Spanish Water Dogs in honor of Scout.



# **WKC 2025 DOG SHOW RV SITES**

## **RV SITES, OVERNIGHT CAMPING & OVERNIGHT PARKING ONLINE RESERVATIONS ONLY OPENS APRIL 1, 2025**

RV reservations can be made at link below. Choose RV button. Instructions and video tutorial available. Two night minimum required. Reservations are made using EventBright.

Site MAP and RV reservation link: [www.waukeshakennelclub.org/summersplashdogshow](http://www.waukeshakennelclub.org/summersplashdogshow)

Location: on-site with the dog show - Waukesha County Exposition Center, 1000 Northview Rd. Showers available on-site.

Parking Site arrivals allowed on **Wednesday, July 23, 2025 from 3:00 P.M. until 10:00 P.M. and Thursday through Saturday July 24 - 26, 2025 from 6:00 A.M. until 10:00 P.M.**

**Quiet time is 10:00 P.M. – 6:00 A.M. following morning.** If you arrive in that time frame, please park near Gate 3 entrance and see the RV Site Coordinator the following morning for directions.

There are limited electrical hook up sites, 50, 30 & 20 amp outlets. There is NO guarantee that electric will be available to all. All site reservations are First come, First served.

No refunds after July 16, 2025.

---

## **ACCOMMODATIONS**

PLEASE BE A RESPONSIBLE MOTEL GUEST. IF THE WAUKESHA KENNEL CLUB, INC. SHOW COMMITTEE IS CONTACTED BY A MOTEL DUE TO ANY PROBLEMS WITH DOG SHOW GUESTS, AN EVENT COMMITTEE HEARING MAY BE IN YOUR FUTURE. If asked by motel management to sign any type of paperwork, please be sure to READ it and understand what it means. Please call to confirm current dog fees.

**Wildwood Lodge**, N14 W24121 Tower Place, PO Box 28, Pewaukee WI 53072 ..... (262) 506-2000  
[www.thewildwoodlodge.com/pewaukee](http://www.thewildwoodlodge.com/pewaukee) Wildwood Lodges has a reserved block of rooms at \$121.00/day, suites are extra. **This rate expired on July 3, 2025.** Reservations will be made by individual. Breakfast included. Dog Policy: \$20.00/dog/night + tax in Std. Rooms. \$30.00/dog/night + tax in Suites, Two dog maximum per room. No breed or size restrictions. Pet Policy Form must be signed at check-in.  
**Comfort Inn Waukesha**, 2510 Plaza Crt., Waukesha, WI 53186 ..... (262) 786-6015  
A room block for Waukesha Kennel Club Exhibitors. Single King Rooms - \$139.00. Double Queen Room - \$149.00. \$20.00/night/pet, pets cannot be left unattended in room at anytime, Two pet maximum, No weight limit. Booking Link: <https://www.choicehotels.com/reservations/groups/DW96B2>

### **OTHER PET FRIENDLY AREA HOTELS**

**Country Inn & Suites**, 1250 S. Moorland Rd., Brookfield, WI 53005 ..... (262) 782-1400  
**Extended Stay America**, 325 N. Brookfield Rd., Brookfield, WI 53045 ..... (262) 782-9300  
**La Quinta Inn Delafield**, 2801 Hillside Dr., Delafield, WI 53018 ..... (262) 373-9794  
**The Ingleside Hotel**, 2810 Golf Rd., Pewaukee, WI 53072 ..... (262) 547-0201  
**Home2 Suites by Hilton**, 650 Larry Crt., Waukesha, WI 53186 ..... (262) 362-2128

---

## **ROUTES TO SHOW**

THE WAUKESHA COUNTY EXPOSITION CENTER is located a short 20 minutes West of Milwaukee with easy access from I-94 - Exit #294 to the South (Hwy. J) to Northview Rd., (Hwy. FDT). Turn Right on Northview Rd. to the Expo entrance.

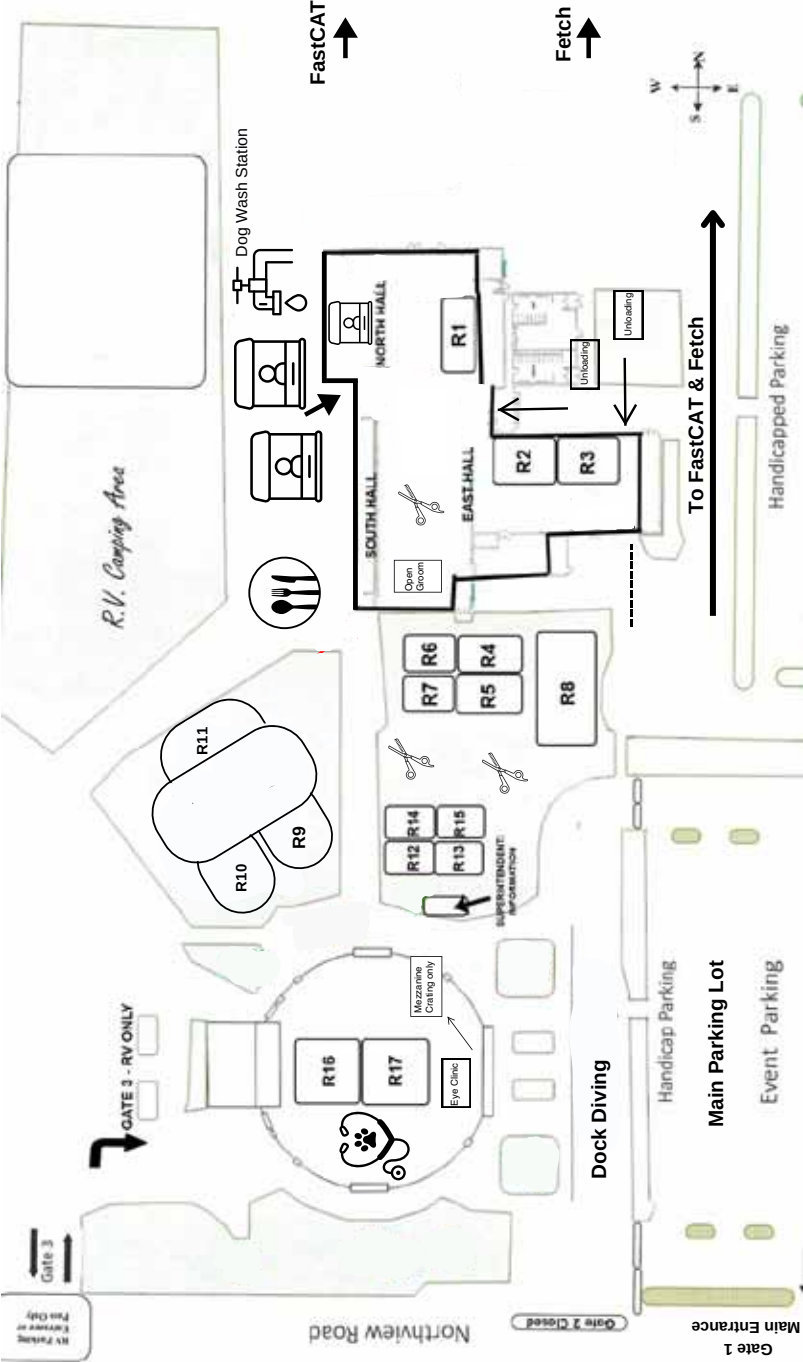

# RESULTS ...

## **REAL Fast**

AS THEY HAPPEN

## **REAL Convenient**

SHOW RESULTS FOR ANY MB-F SHOW  
IN YOUR EMAIL, OR VIA TEXT.

## **REAL Affordable**

(FREE! FIRST 30 DAYS OF NEW  
MY INFODOG PROFESSIONAL MEMBERSHIP)

## **REAL Easy**

JUST GO TO

[www.infodog.com/my/plans/index.htm](http://www.infodog.com/my/plans/index.htm)

*For details and to sign up.*



...YOU'LL BE

# **REAL HAPPY!**

## MY INFODOG MEMBERSHIP PLANS

Program Membership Level			
Features Available	Professional	Deluxe	Standard
<b>Show Entry Filler</b> Use our online entry system to print your entry forms with NO administrative fee.	✓	✓	✓
<b>Dial-N-Entry®</b> Toll free, convenient operator assisted entries, with your administrative fee discount applied.	✓	✓	✓
<b>Priority Entry Closing Information</b> Notification of available PLs, JPs, Closing Dates and Results.	✓	✓	✓
<b>Online Transaction History Reports</b> Your online entry history sent to your e-mail address.	✓	✓	✓
<b>InfoDog Quick Links</b> Collect your favorite InfoDog links into one easy to use page.	✓	✓	✓
<b>InfoDog's National Breeders' Directory</b> Get listed as a breeder in this extensive nationwide breeders' directory.	✓	✓	✓
<b>Odds on a Major</b> Search upcoming MB-F shows likely to be a Major.	✓	✓	
<b>Administrative Fee Discount</b> Lower administrative fees for all online entries	<b>30%</b>	<b>20%</b>	
<b>Dog List Filter</b> Easily filter unwanted dogs from account list when making online entries	✓	✓	
<b>Dog Record Lookup</b> Click any dog in our results section and see the dog's full MB-F show record.	✓	✓	
<b>Unlimited WABR Dogs and Wins</b> Monthly membership fee covers as many dogs and wins as you want.	✓	✓	
<b>Automatic Winners of the Week Listings</b> All winning WABR dogs will appear in <i>Winners of the Week</i> listings.	✓	✓	
<b>Automatic BIS Listings</b> All BIS WABR dogs will appear on the InfoDog home page.	✓	✓	
<b>Priority E-mail Information</b> Be notified of available PLs, JPs, Closing Dates and Results.	✓	✓	
<b>World's Best Web-based Kennel Management® Software</b> Comprehensive web-based kennel management software for serious breeders.	✓		
<b>Ultimate Event Search</b> Search our shows using many parameters. Includes an interactive map.	✓		
<b>Pro Card Manager</b> Securely maintain multiple credit cards for online entries.	✓		
<b>Real Time Results</b> Results alerts sent to you as they are keyed in at shows with internet connectivity. <b>NEW:</b> Option to automatically post wins to Facebook and Twitter.	✓		
<b>Monthly Cost:</b>	<b>\$10.95</b>	<b>\$9.95</b>	<b>\$7.95</b>

To begin your **FREE** 30-day trial go to:

**[www.infodog.com/my/plans/index.htm](http://www.infodog.com/my/plans/index.htm)**

(Prices effective May 1, 2023. Subject to change without notice)



# ALWAYS RAISING OUR STANDARD



# TO MEET YOURS

The premium nutrition you trust, now with **unlimited rewards** and **more exclusive benefits**.



Access to  
Reproductive Diets



Crown Partner  
Pricing



Free Puppy  
Kits



Expert  
Support

**CROWN PARTNERS**  
BREEDER LOYALTY PROGRAM

Join our community  
dedicated to breeders.  
Scan & Sign-up!

